

### Section A-A

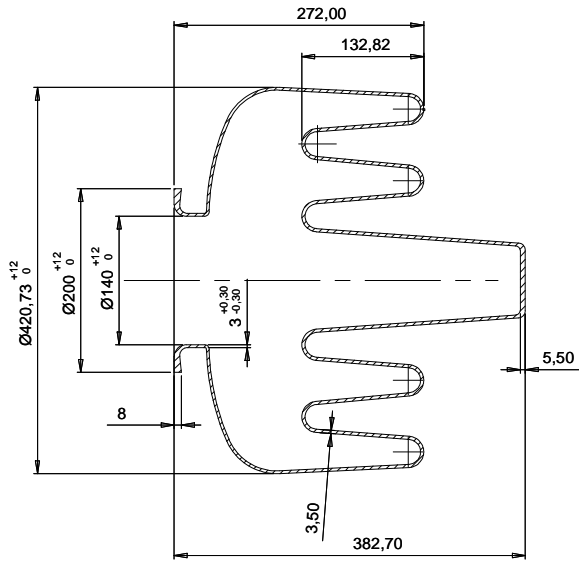

### Section B-B

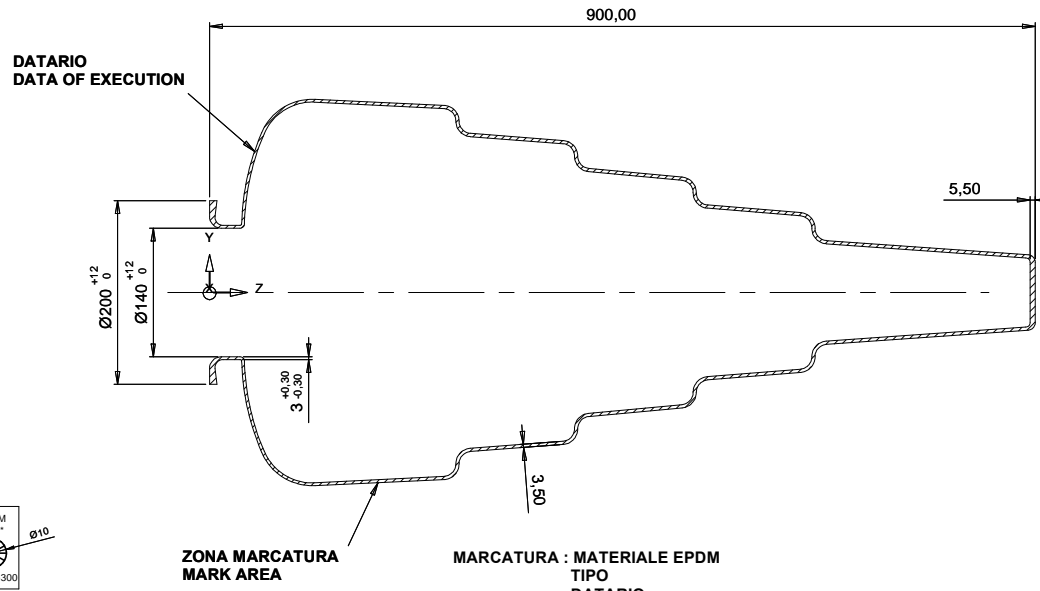

ZONA MARCATURA  
MARK AREA

MARCATURA : MATERIALE EPDM  
TIPO  
DATARIO  
N°VANO \*

MARK : MATERIAL EPDM  
TYPE  
DATA OF EXECUTION  
CAVITY N° \*

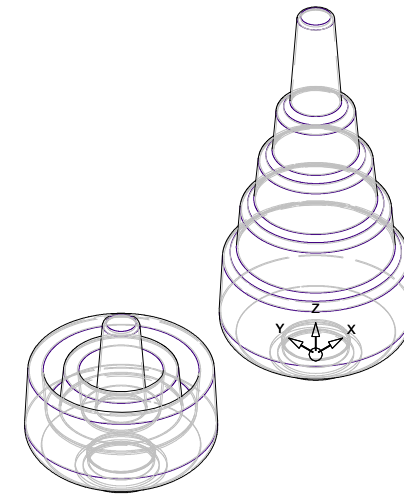
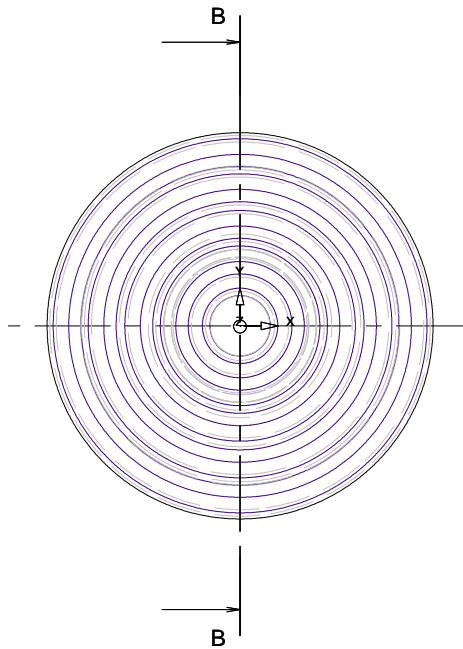
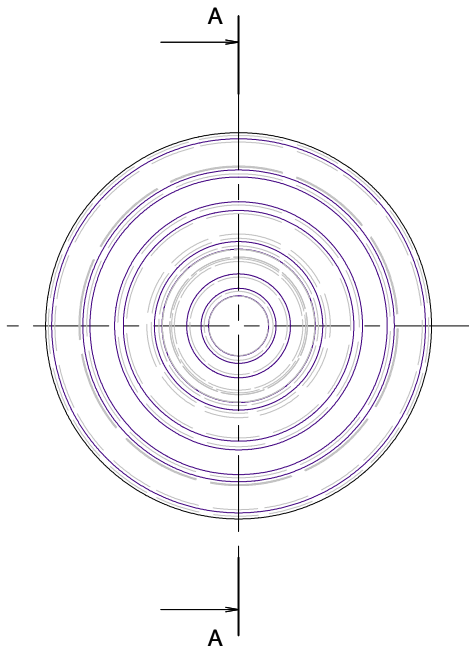

LUNGHEZZA SVILUPPATA RAGGIUNGIBILE  
SENZA DEFORMAZIONI 1250 mm

DEVELOPED LENGHT ACHIEVABLE  
WITHOUT DEFORMATIONS 1250 mm

QUOTE SENZA INDICAZIONE DI TOLLERANZA SECONDO : UNI ISO 2768-m	Toll. generali foro: H8 Dim. lineari: J8 Albero : h8 Angoli : 0°30'		
--	--	--	--

# Techni Pompe.fr

Vente de pompes, accessoires & pièces détachées de pompe

Data: 09-10-2015	1/1	VISTO:	COMMESSA N°: 9614
Rev. 0.1	Data: 29-08-2005	Cod. Mod. MCB 7.03.2	

MODIFICHE:

**Section A-A**

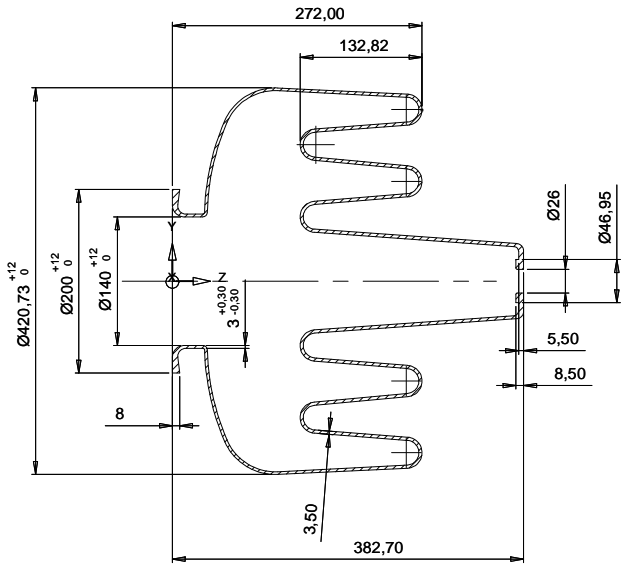

**Section B-B**

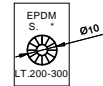
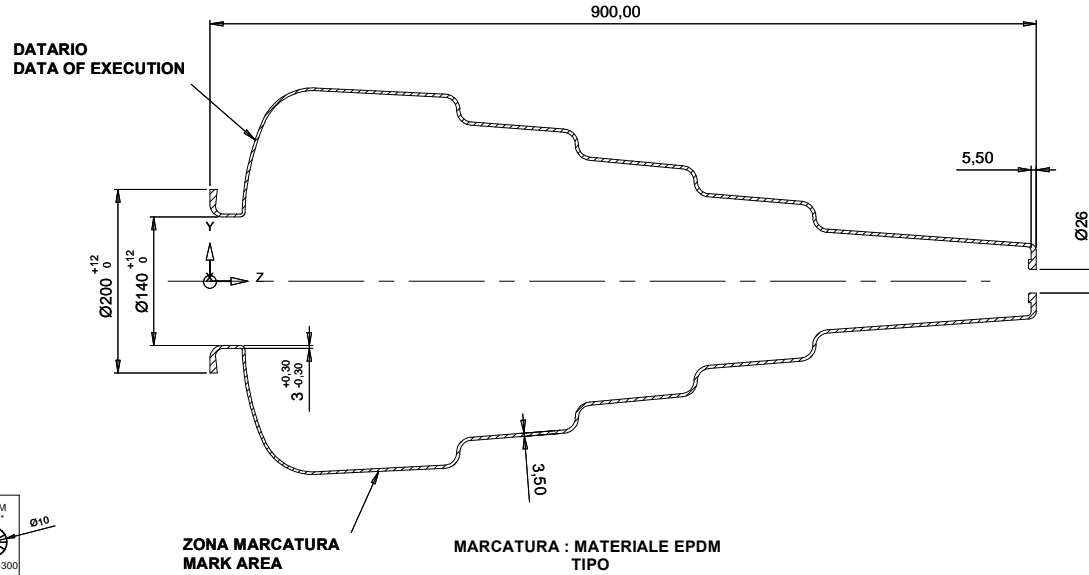

ZONA MARCATURA  
MARK AREA

MARCATURA : MATERIALE EPDM  
TIPO  
DATARIO  
N°VANO \*

MARK : MATERIAL EPDM  
TYPE  
DATA OF EXECUTION  
CAVITY N° \*

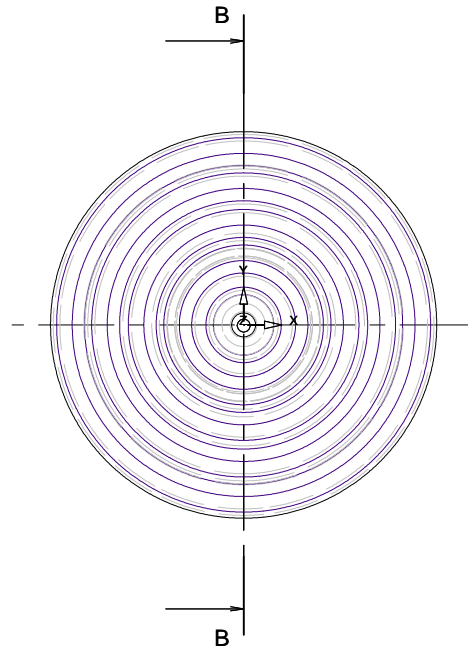
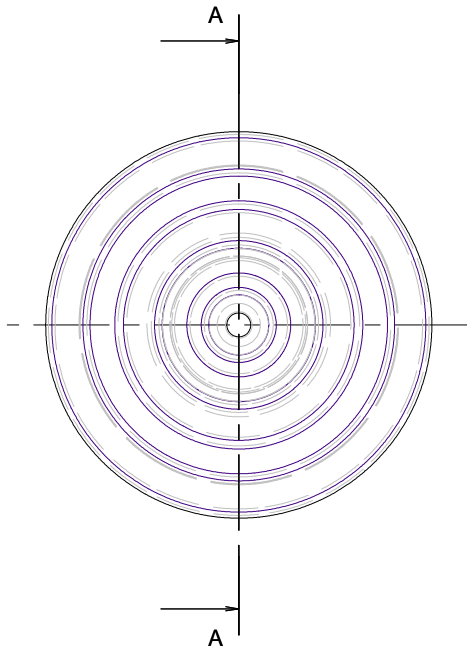
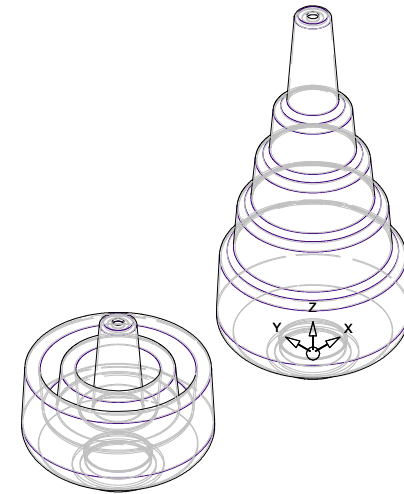

LUNGHEZZA SVILUPPATA RAGGIUNGIBILE  
SENZA DEFORMAZIONI 1250 mm

DEVELOPED LENGHT ACHIEVABLE  
WITHOUT DEFORMATIONS 1250 mm

QUOTE SENZA INDICAZIONE DI TOLLERANZA SECONDO : UNI ISO 2768-m	Toll. generali foro: h8 Albero : h8	H8 Dim. lineari: j8 Angoli : 0°30'			9613
<b>Techni Pompe.fr</b>		Vente de pompes, accessoires & pièces détachées de pompe			
Disegnato da: <b>BOLLER</b>	1/1	VISTO:	COMMESSA N°:		
Data: <b>09-10-2015</b>					
Rev. 0.1	Data: 23-06-2005	Cod. mod. MB 7.03.3			

**Section A-A**

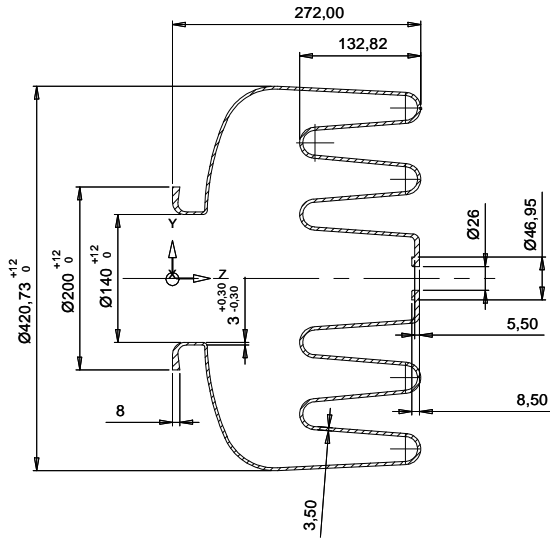

**Section B-B**

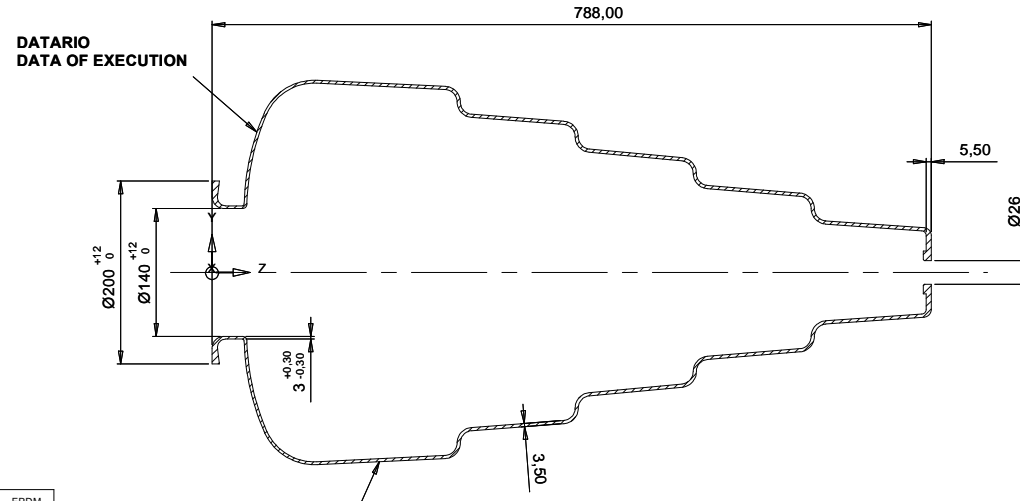

**ZONA MARCATURA  
MARK AREA**

**MARCATURA : MATERIALE EPDM  
TIPO DATARIO  
N°VANO \***

**MARK : MATERIAL EPDM  
TYPE DATA OF EXECUTION  
CAVITY N° \***

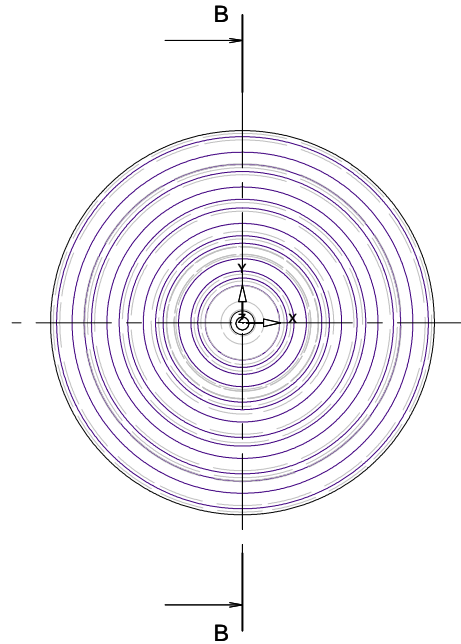
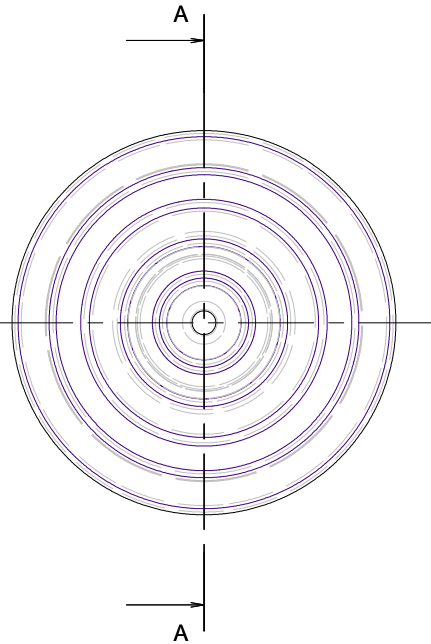
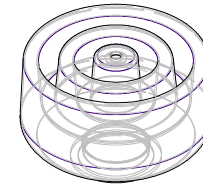
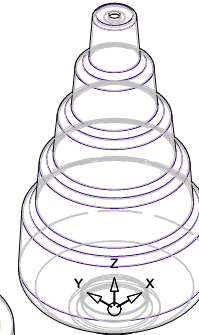

**LUNGHEZZA SVILUPPATA RAGGIUNGIBILE  
SENZA DEFORMAZIONI 1100 mm**

**DEVELOPED LENGHT ACHIEVABLE  
WITHOUT DEFORMATIONS 1100 mm**

QUOTE SENZA INDICAZIONE DI TOLLERANZA SECONDO : UNI 100 2768-m	Toll. generali foro: H8 Dim. lineari: J8 Albero : h8 Angoli : 0°30'		
--	--	--	--

# Techni Pompe.fr

Vente de pompes, accessoires & pièces détachées de pompe

<b>Disegnato:</b> BOFFERO		<b>VISTO:</b>	<b>COMMESSA N°:</b>
<b>Data:</b> 09-10-2015	<b>1/1</b>		<b>9615</b>
<small>Rev. n. 1</small>	<small>Data 29-06-2005</small>	<small>Cod. mod. M3 7.01.5</small>	

PRODOTTORE:

NEL TRATTO A-B LO SPESSORE VARIA DA 3,5 A 5mm  
 BETWEEN A-B THE THICKNESS VARIE FORM 3,5 TO 5 mm

**Section A-A**

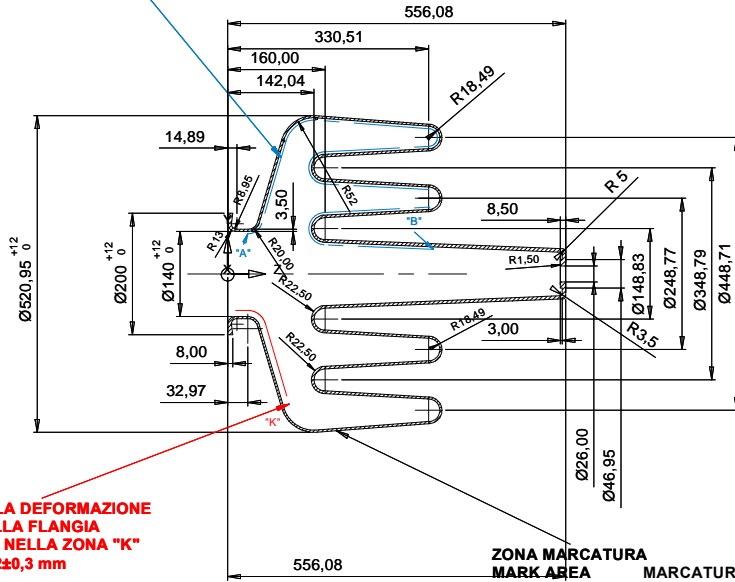

**Section B-B**

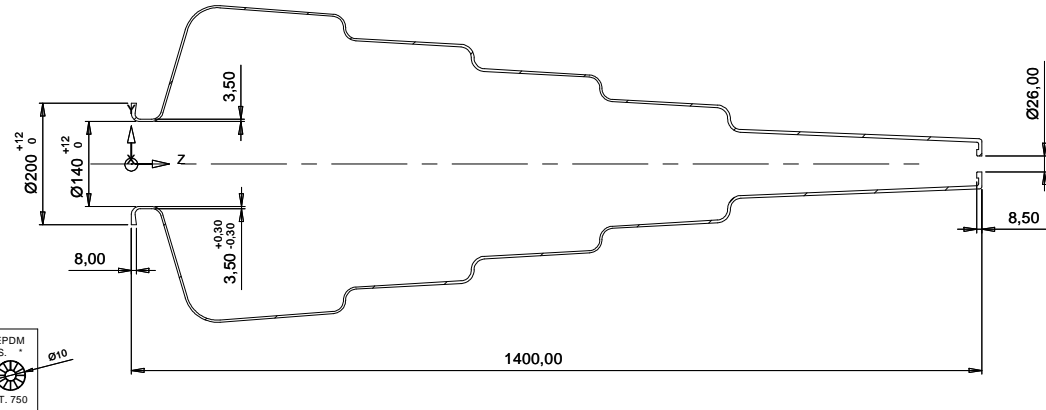

**A CAUSA DELLA DEFORMAZIONE  
 IN USCITA DALLA FLANGIA  
 LO SPESSORE NELLA ZONA "K"  
 PUO ESSERE 2±0,3 mm**

**BECAUSE FLANGE'S DEFORMATION  
 WHWN CAME OUT THE THICKNESS IN K  
 ZONE CAN BE 2±0,3 mm**

**ZONA MARCATURA  
 MARK AREA**

MARCATURA : MATERIALE EPDM  
 TIPO DATARIO  
 N°VANO \*

MARK : MATERIAL EPDM  
 TYPE DATA OF EXECUTION  
 CAVITY N° \*

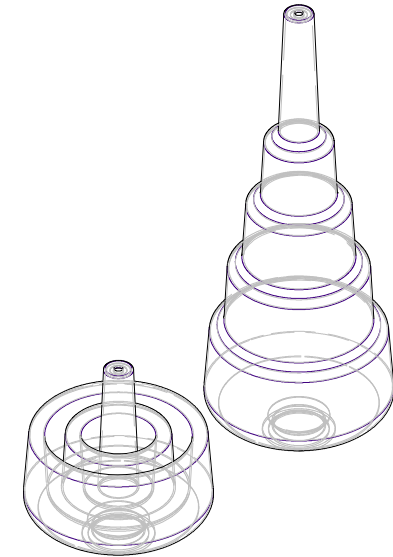
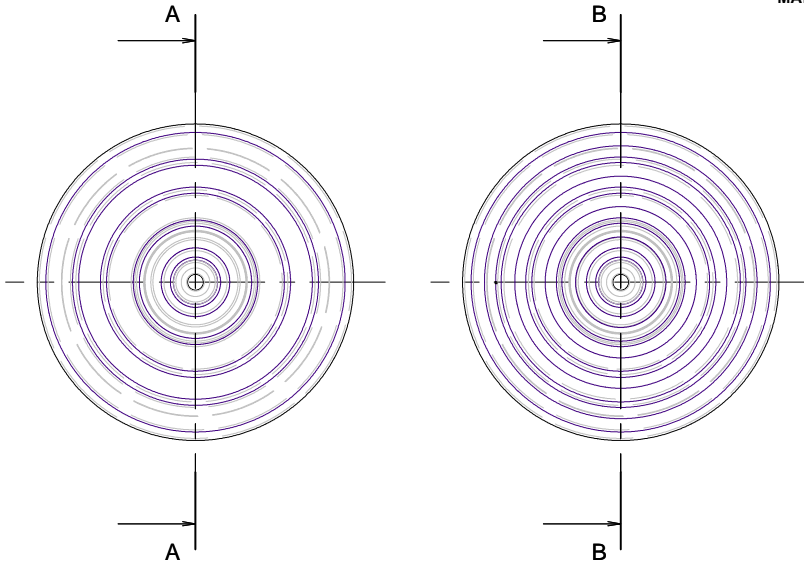

LUNGHEZZA SVILUPPATA RAGGIUNGIBILE  
 SENZA DEFORMAZIONI 1800 mm

DEVELOPED LENGHT ACHIEVABLE  
 WITHOUT DEFORMATIONS 1800 mm

QUOTE SENZA INDICAZIONE DI TOLLERANZA SECONDO * UNI ISO 2768-m	Toll. generali foro: H8 Dim. lineari: JS Albero : h8 Angoli : 0°30'	
--	--	--

**Techni Pompe.fr**  
 Vente de pompes, accessoires & pièces détachées de pompe

Data: <b>08-10-2015</b>	1/1	VISTO:	COMMESSA N°:
REV. N. 1	DATA 20-04-2005	Doc. Mod. M08 7.03.3	<b>9605</b>



NEL TRATTO A-B LO SPESSORE VARIA DA 3,5 A 5mm  
 BETWEEN A-B THE THICKNESS VARIE FORM 3,5 TO 5 mm

CAPACITA'  
 CAPACITY: 106280000 mm<sup>3</sup>

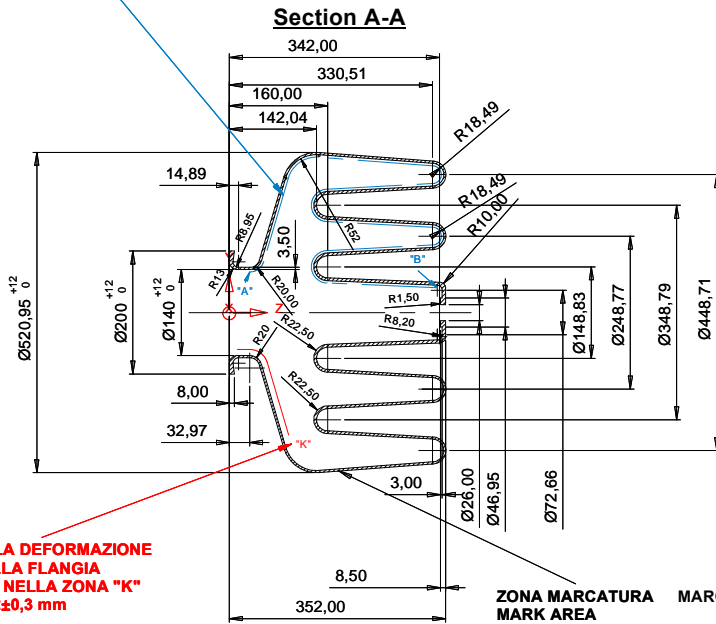

**Section B-B**

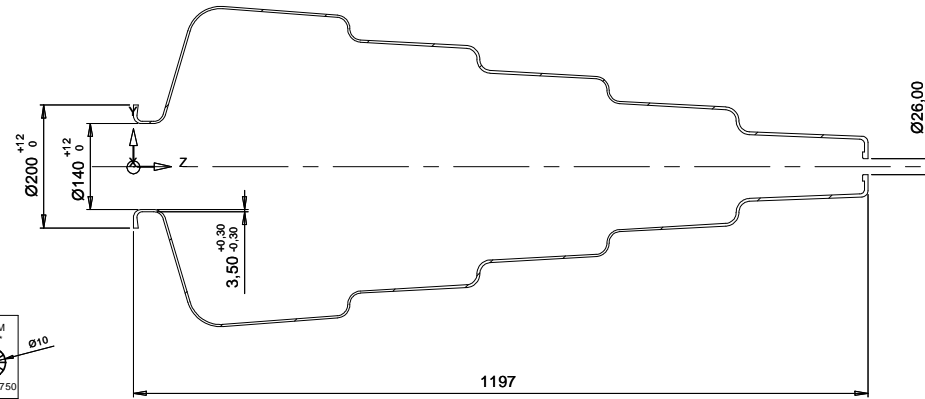

A CAUSA DELLA DEFORMAZIONE  
 IN USCITA DALLA FLANGIA  
 LO SPESSORE NELLA ZONA "K"  
 PUO ESSERE 2±0,3 mm

BECAUSE FLANGE'S DEFORMATION  
 WHWN CAME OUT THE THICKNESS IN K  
 ZONE CAN BE 2±0,3 mm

ZONA MARCATURA  
 MARK AREA

MARCATURA : MATERIALE EPDM  
 TIPO  
 DATARIO  
 N°VANO \*

MARK : MATERIAL EPDM  
 TYPE  
 DATA OF EXECUTION  
 CAVITY N° \*

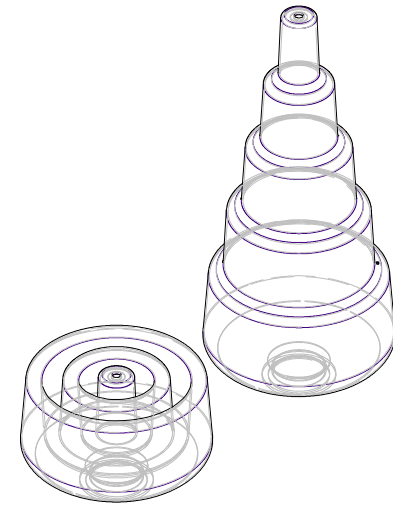
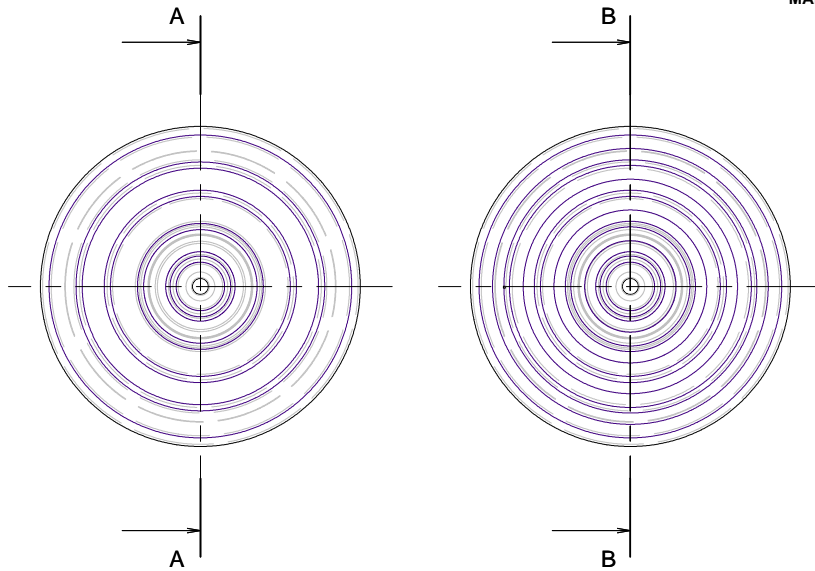

LUNGHEZZA SVILUPPATA RAGGIUNGIBILE  
 SENZA DEFORMAZIONI 1600 mm

DEVELOPED LENGHT ACHIEVABLE  
 WITHOUT DEFORMATIONS 1600 mm

QUOTE SENZA INDICAZIONE DI TOLLERANZA SECONDO : UNI ISO 2768-m		Toll. generali foro: H8 Dim. lineari: j8 Albero: h8 Angoli: 0°30'		MODEL PUMP:
<p>Vente de pompes, accessoires &amp; pièces détachées de pompe</p>				
Disegnatore: <b>BOLLERO</b>	Data: <b>08-10-2015</b>	Fog. N°: <b>1/1</b>	VISTO:	COMMESSA N°: <b>9603</b>
Rev: 0,1	Data: 29/09/2005	Cod. Mod. N°: 7.03.2		

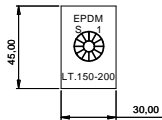

**ZONA MARCATURA  
MARK AREA**

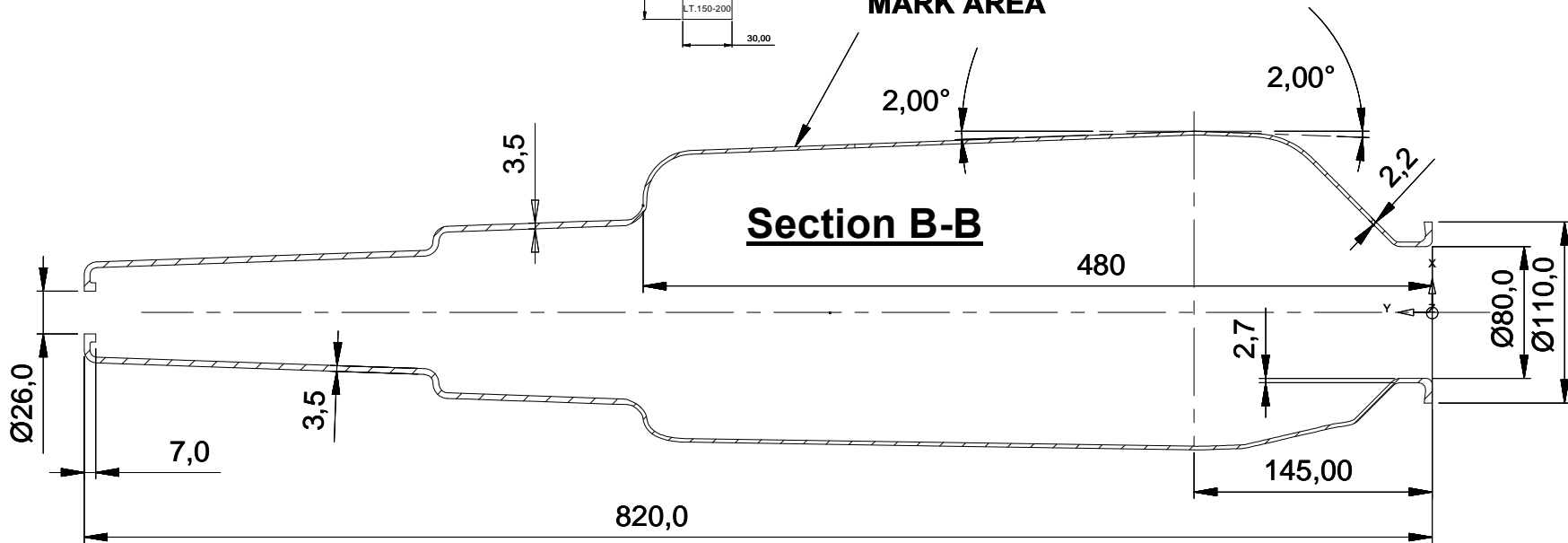

**Section B-B**

**MARCATURA : MATERIALE EPDM  
TIPO  
DATARIO  
N°VANO 1-4**

**MARK : MATERIAL EPDM  
TYPE  
DATA OF EXECUTION  
CAVITY N° 1-4**

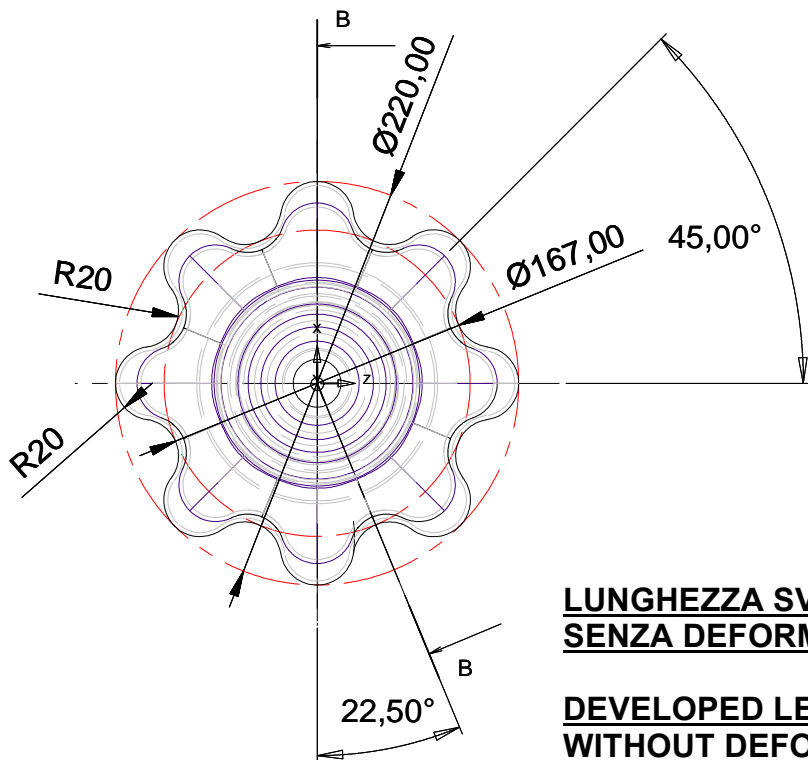
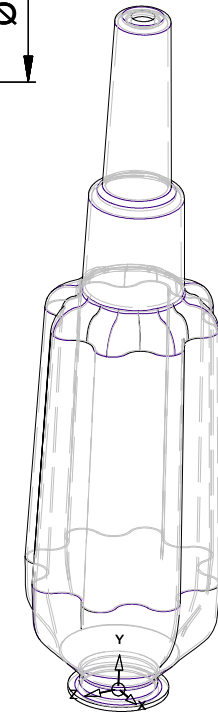

**LUNGHEZZA SVILUPPATA RAGGIUNGIBILE  
SENZA DEFORMAZIONE 926 mm**

**DEVELOPED LENGHT ACHIEVABLE  
WITHOUT DEFORMATIONS 926 mm**

QUOTE SENZA INDICAZIONE DI TOLLERANZA SECONDO : UNI ISO 2768-m		Toll. generali foro: H8 Dim. lineari: j8 Albero : h8 Angoli : 0°30'				MODIFICHE:
				Vente de pompes, accessoires & pièces détachées de pompe		
Data:	07-10-2015	1/1	VISTO:	COMMESSA N°: 9644		
Rev. N. 1	Date	20-06-2005	Doc. mod. M2 1.01.1			

ZONA MARCATURA  
MARK AREA

# Section B-B

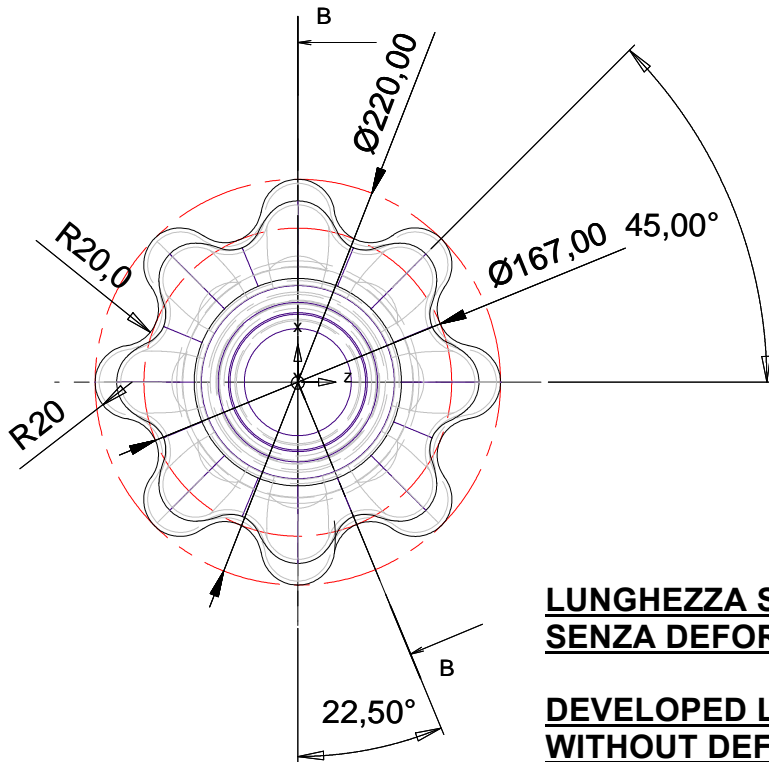
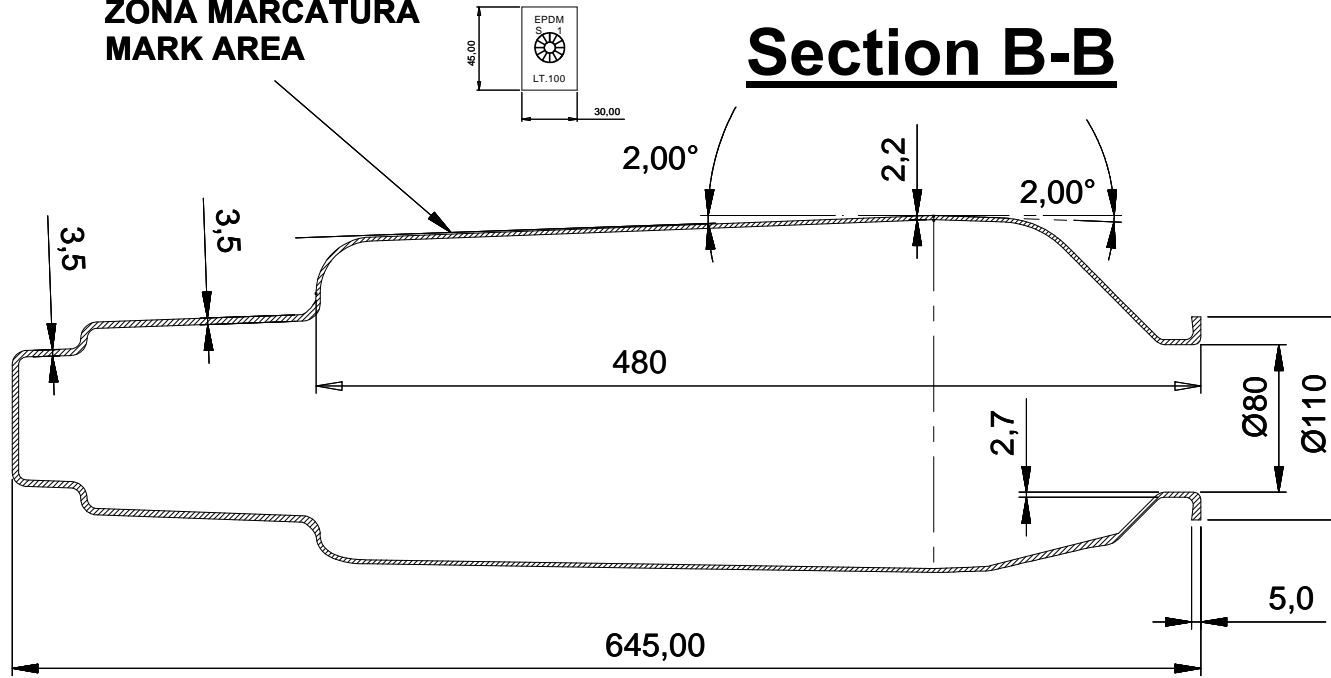

MARCATURA : MATERIALE EPDM  
TIPO  
DATARIO  
N°VANO 1-4

MARK : MATERIAL EPDM  
TYPE  
DATA OF EXECUTION  
CAVITY N° 1-4

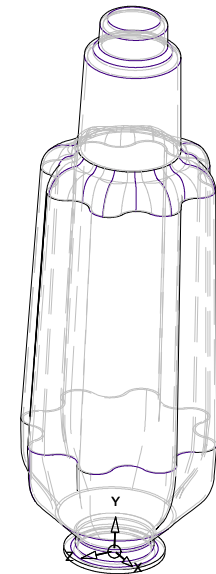

**LUNGHEZZA SVILUPPATA RAGGIUNGIBILE  
SENZA DEFORMAZIONE 698 mm**

**DEVELOPED LENGHT ACHIEVABLE  
WITHOUT DEFORMATIONS 698 mm**

QUOTE SENZA INDICAZIONE DI TOLLERANZA SECONDO : UNI ISO 2768-m		Toll. generali foro : H8 Dim. lineari : j8 Albero : h8 Angoli : 0°30'			MODIFICHE:
<b>Techni Pompe.fr</b> Vente de pompes, accessoires & pièces détachées de pompe					
Data: 07-10-2015	1/1	VISTO:	COMMESSA N°: 9640		
Rev. 0, 1	Data: 20-03-2005	Cod. mod. MOD 7-03.2			



ZONA MARCATURA  
MARK AREA

# Section B-B

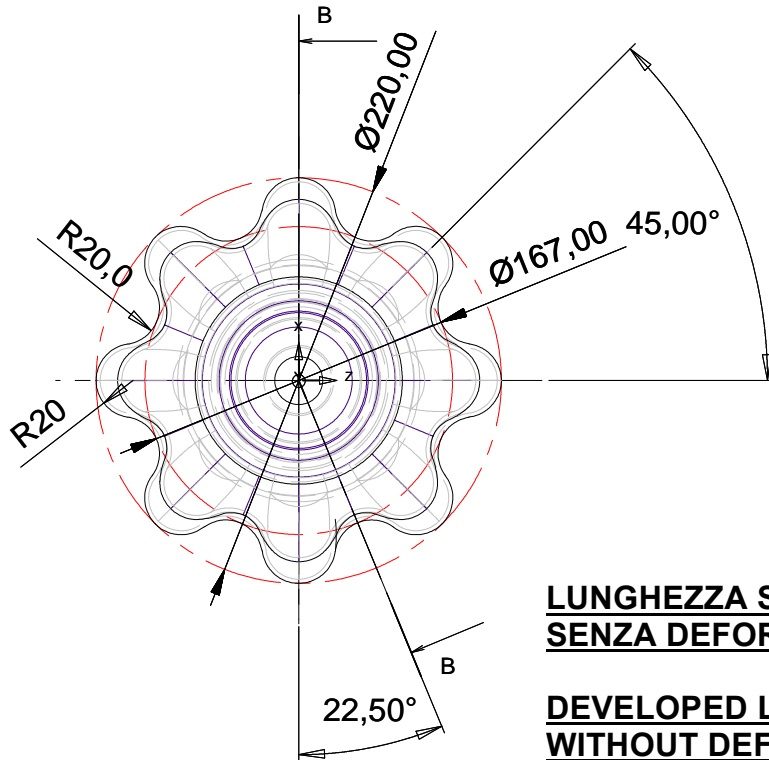
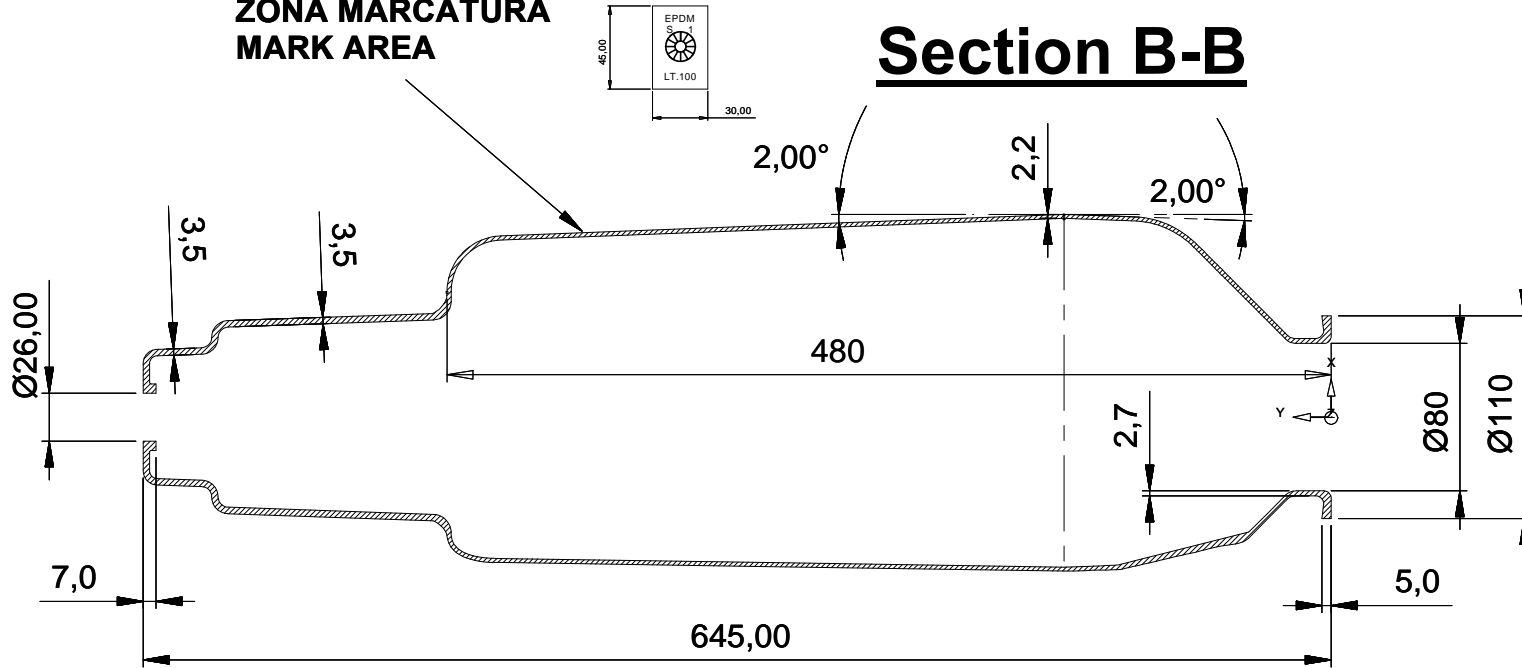

MARCATURA : MATERIALE EPDM  
TIPO  
DATARIO  
N°VANO 1-4

MARK : MATERIAL EPDM  
TYPE  
DATA OF EXECUTION  
CAVITY N° 1-4

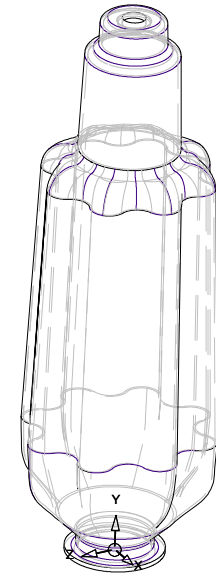

**LUNGHEZZA SVILUPPATA RAGGIUNGIBILE  
SENZA DEFORMAZIONE 698 mm**

**DEVELOPED LENGHT ACHIEVABLE  
WITHOUT DEFORMATIONS 698 mm**

QUOTE SENZA INDICAZIONE DI TOLLERANZA SECONDO : UNI ISO 2768-m		Toll. generali foro: H8 Dim. lineari: 30 Albero : h8 Angoli : 0°30'	
<b>Techni Pompe.fr</b> Vente de pompes, accessoires & pièces détachées de pompe			
Disegnatore: <b>BOITERO</b>		VISTO:	
Data: <b>07-10-2015</b>	<b>1/1</b>	COMMESSA N°:	<b>9641</b>
Rev. N. 1	Data 20-04-2005	Cod. mod. MGR 1.01.3	

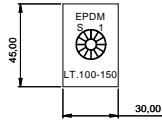

**ZONA MARCATURA  
MARK AREA**

**CAPACITA'  
CAPACITY = 19.828.890 mm<sup>3</sup>**

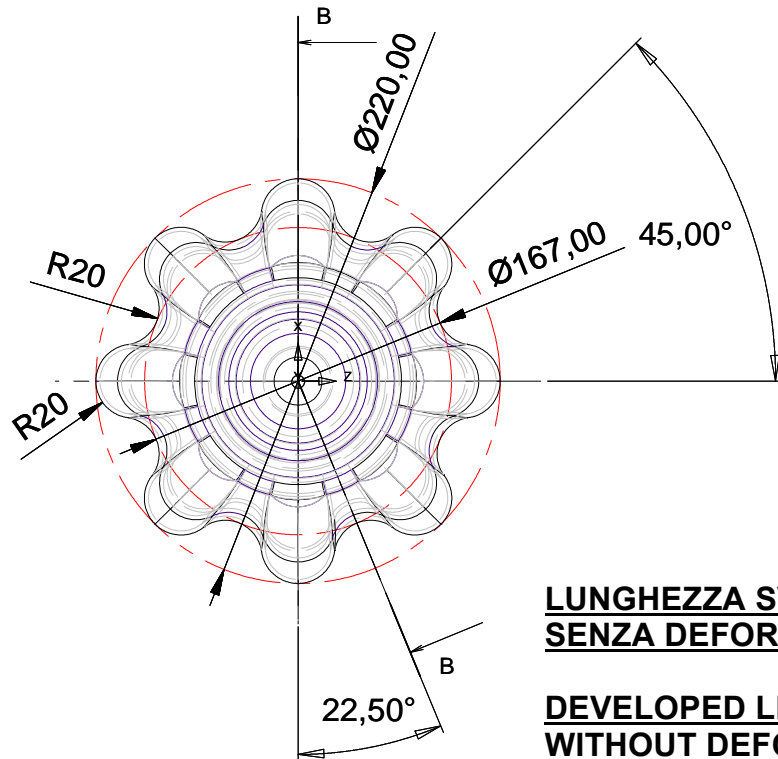
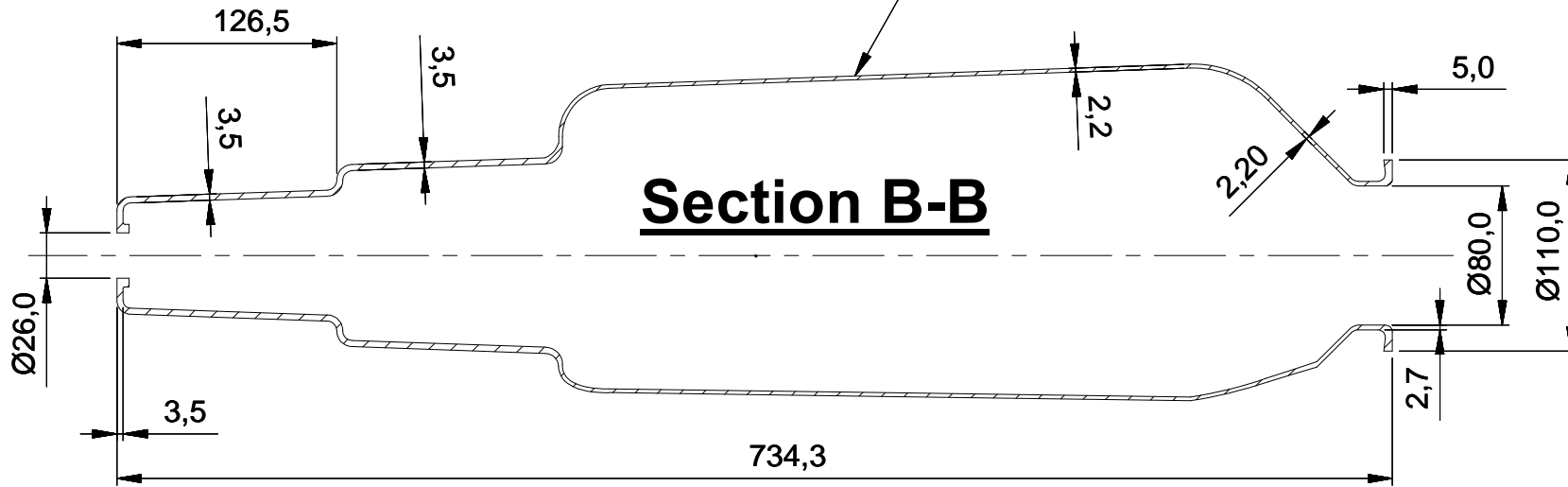

**LUNGHEZZA SVILUPPATA RAGGIUNGIBILE  
SENZA DEFORMAZIONE 840 mm**

**DEVELOPED LENGTH ACHIEVABLE  
WITHOUT DEFORMATIONS 840 mm**

**MARCATURA : MATERIALE EPDM  
TIPO  
DATARIO  
N°VANO 1-4**

**MARK : MATERIAL EPDM  
TYPE  
DATA OF EXECUTION  
CAVITY N° 1-4**

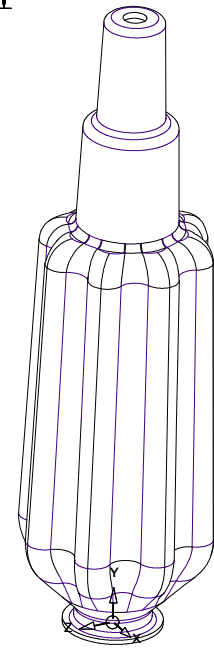

QUOTE SENZA INDICAZIONE DI TOLLERANZA SECONDO : UNI ISO 2768-m		Toll. generali foro: h8 Dim. lineari: j8 Albero : h8 Angoli : 0°30'		MODIFICHE:
<b>Techni Pompe.fr</b> Vente de pompes, accessoires & pièces détachées de pompe				
Data: 24-02-2015	1/1	VISTO:	COMMESSA N°:	9643 FS
Rev. R. 1	Data 29-06-2005	Cod. mod. MCP 7.03.3		

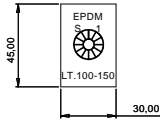

**ZONA MARCATURA  
MARK AREA**

**CAPACITA'  
CAPACITY = 19.828.890 mm<sup>3</sup>**

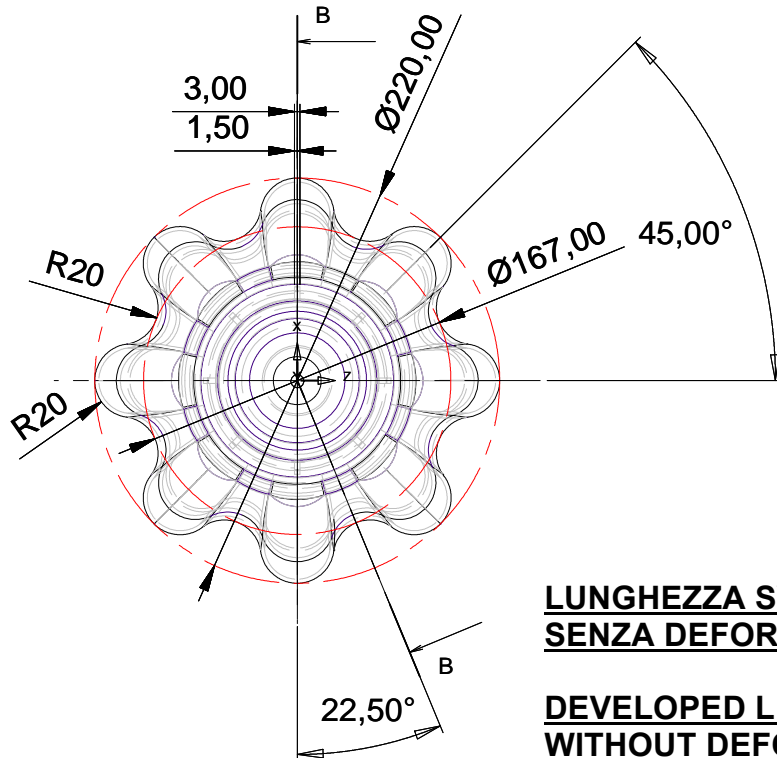
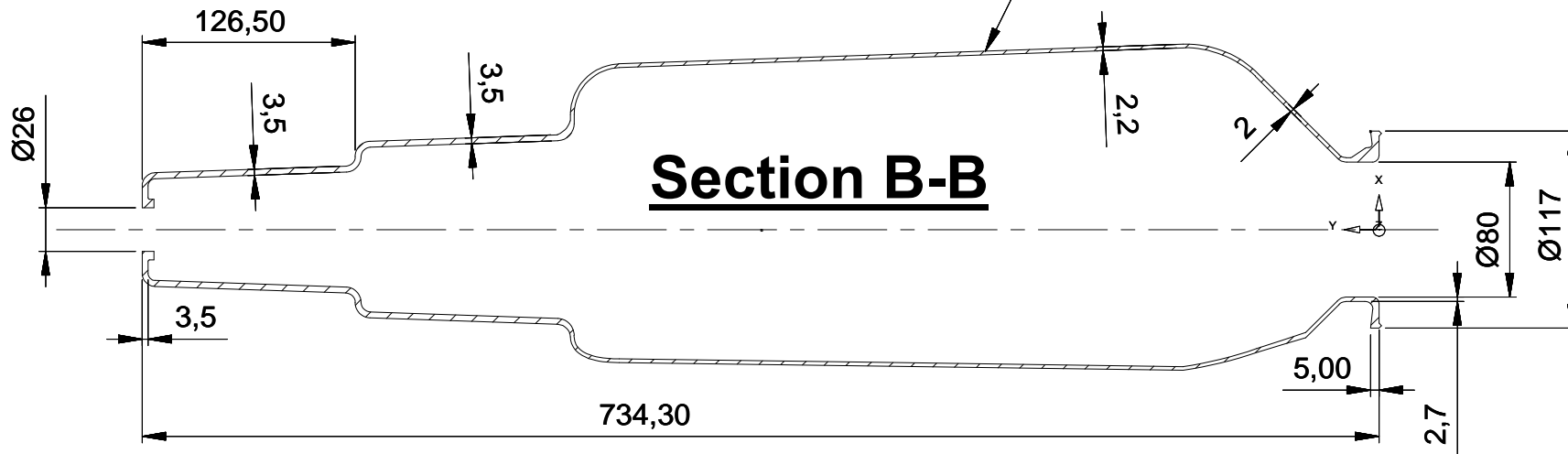

**MARCATURA : MATERIALE EPDM  
TIPO  
DATARIO  
N°VANO 1-4**

**MARK : MATERIAL EPDM  
TYPE  
DATA OF EXECUTION  
CAVITY N° 1-4**

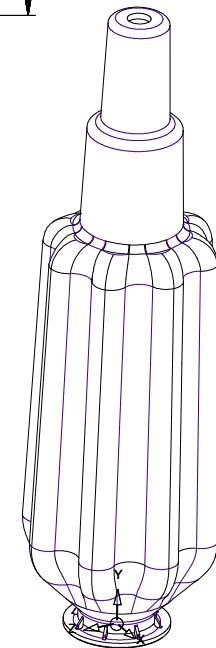

**LUNGHEZZA SVILUPPATA RAGGIUNGIBILE  
SENZA DEFORMAZIONE 840 mm**

**DEVELOPED LENGHT ACHIEVABLE  
WITHOUT DEFORMATIONS 840 mm**

<small>QUOTE SENZA INDICAZIONE DI TOLLERANZA SECONDO : UNI ISO 2768-m</small>		<small>Toll. generali foro: H8 Dim. lineari: j8</small>		<small>Albero : h8 Angoli : 0°30'</small>	
<b>Vente de pompes, accessoires &amp; pièces détachées de pompe</b>					
<small>BOITIERO</small>		<small>1/1</small>		<small>COMMESSA N°:</small>	
<small>Data:</small> 06-10-2015		<small>VISTO:</small>		<b>9643 FL</b>	
<small>Rev. 0.1</small>		<small>Data 23-04-2015</small>		<small>cod. mod. MOP 1-03.3</small>	

**Section A-A**

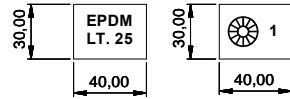
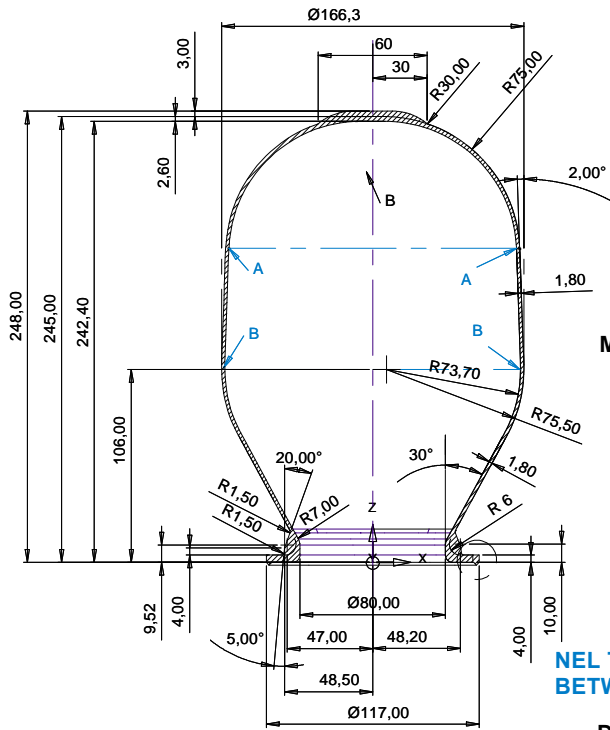

**Section B-B**

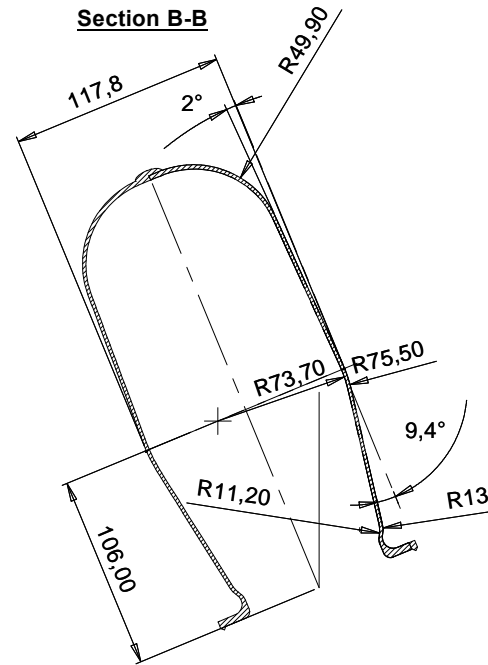

**MARCATURA : MATERIALE ---  
TIPO  
DATARIO  
N°VANO 1-12**

**MARK : MATERIAL ---  
TYPE  
DATA OF EXECUTION  
CAVITY N° 1-12**

**NEL TRATTO A-B LO SPESSORE VARIA DA 1,8 A 2,6 mm  
BETWEEN A-B THE THICKNESS VARIES FROM 1,8 TO 2,6 mm**

**DETTAGLIO C**

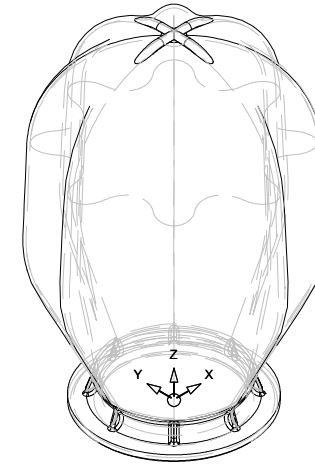
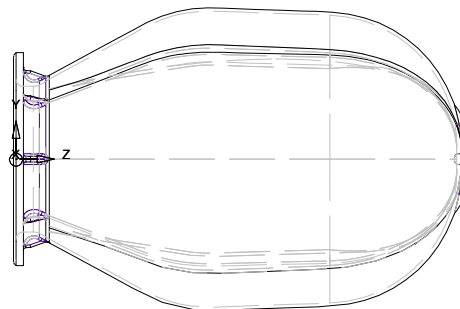
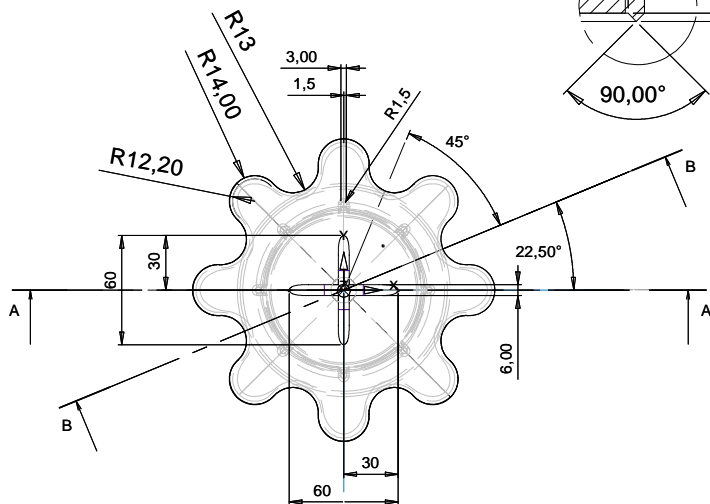
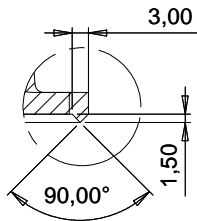

QUOTE SENZA INDICAZIONE DI TOLLERANZA SECONDO : UNI ISO 2768-m		Toll. generali foro: H8 Dim. lineari: J8		Albero : h8 Angoli : 0°30'	
<b>Techni Pompe.fr</b>					
Vente de pompes, accessoires & pièces détachées de pompe					
Disegnatore: <b>BOTTERO</b>		Fav. N°:		Pg. N°:	
Data: <b>30-09-2015</b>		<b>1/1</b>		VISTO:	
REV. N°: 1		Data: 29-08-2005		Cod. mod. MP 1.03.3	
					<b>9705</b>

PRODOTTORE:

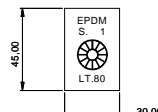

MARCATURA : MATERIALE EPDM  
TIPO  
DATARIO  
N°VANO 1-4

MARK : MATERIAL EPDM  
TYPE  
DATA OF EXECUTION  
CAVITY N° 1-4

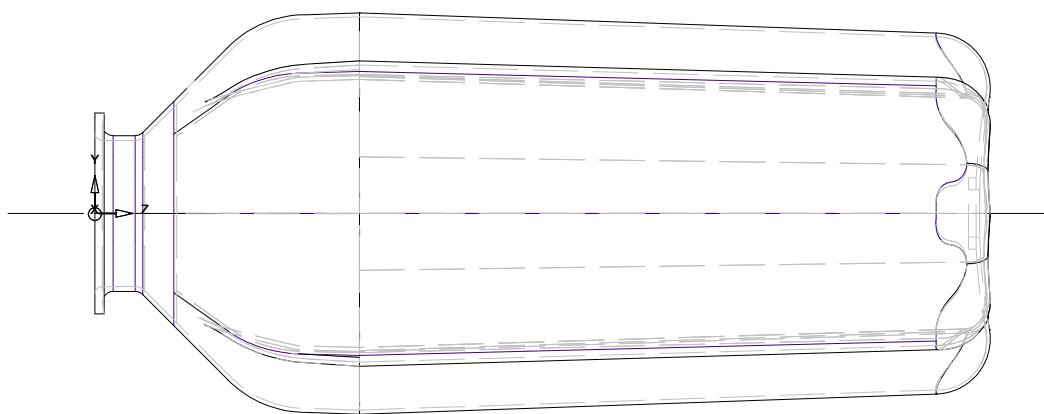
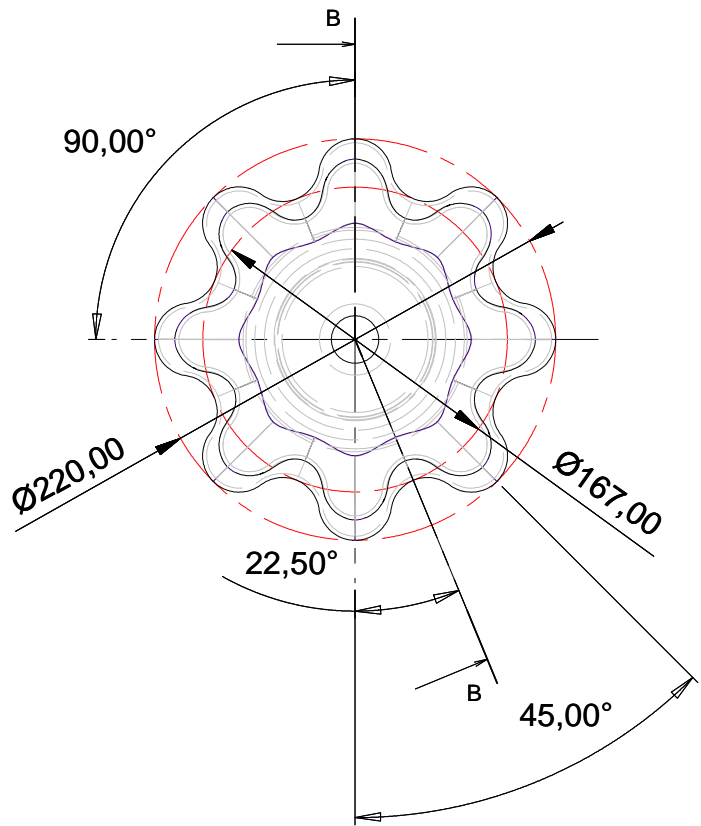
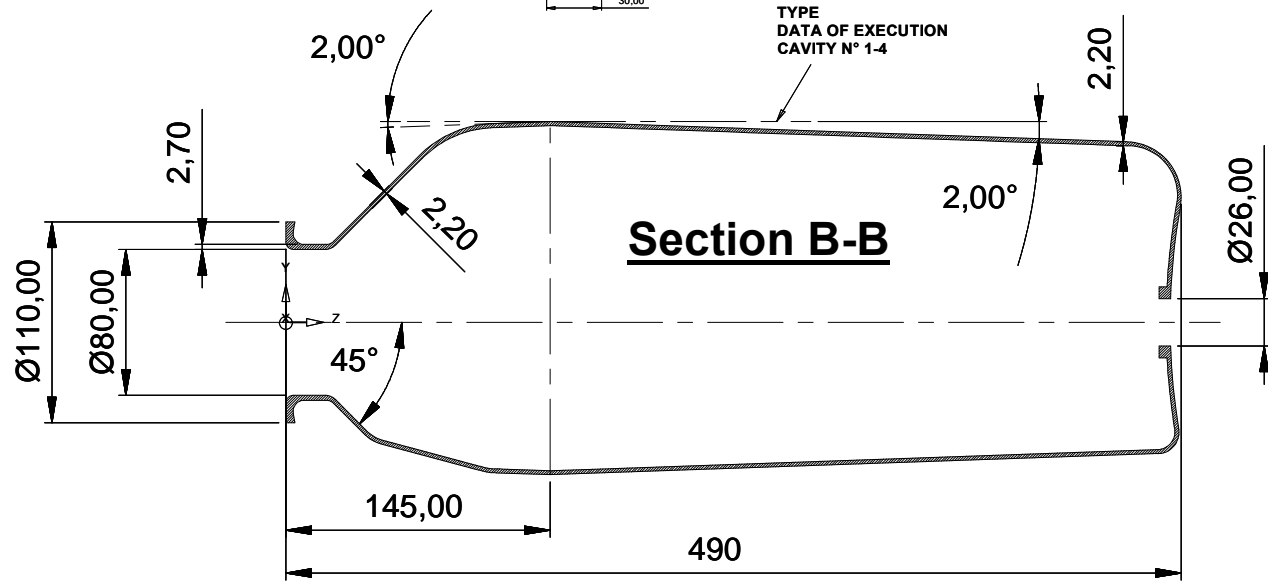

QUOTE SENZA INDICAZIONE DI TOLLERANZA SECONDO : UNI ISO 2768-m		Toll. generali foro: H8 Dim. lineari: JS Albero : h8 Angoli : 0°30'		
<h1>Techni Pompe.fr</h1> <p>Vente de pompes, accessoires &amp; pièces détachées de pompe</p>				
Disegnatore: <b>BOTTERO</b>	Fav. N°:	Pg. N°:	VISTO:	
Data: <b>02-10-2015</b>	<b>1/1</b>	COMMESSA N°:		<b>9639</b>
<small>Rev. 0.1</small>	<small>Data: 29-02-2015</small>	<small>Doc. Mod. M3 1.03.3</small>		

MODIFICHE:

# Section B-B

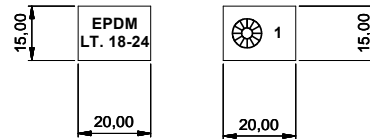
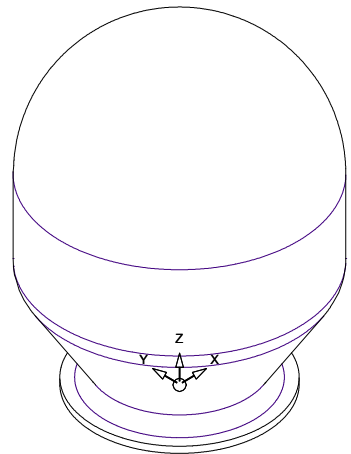
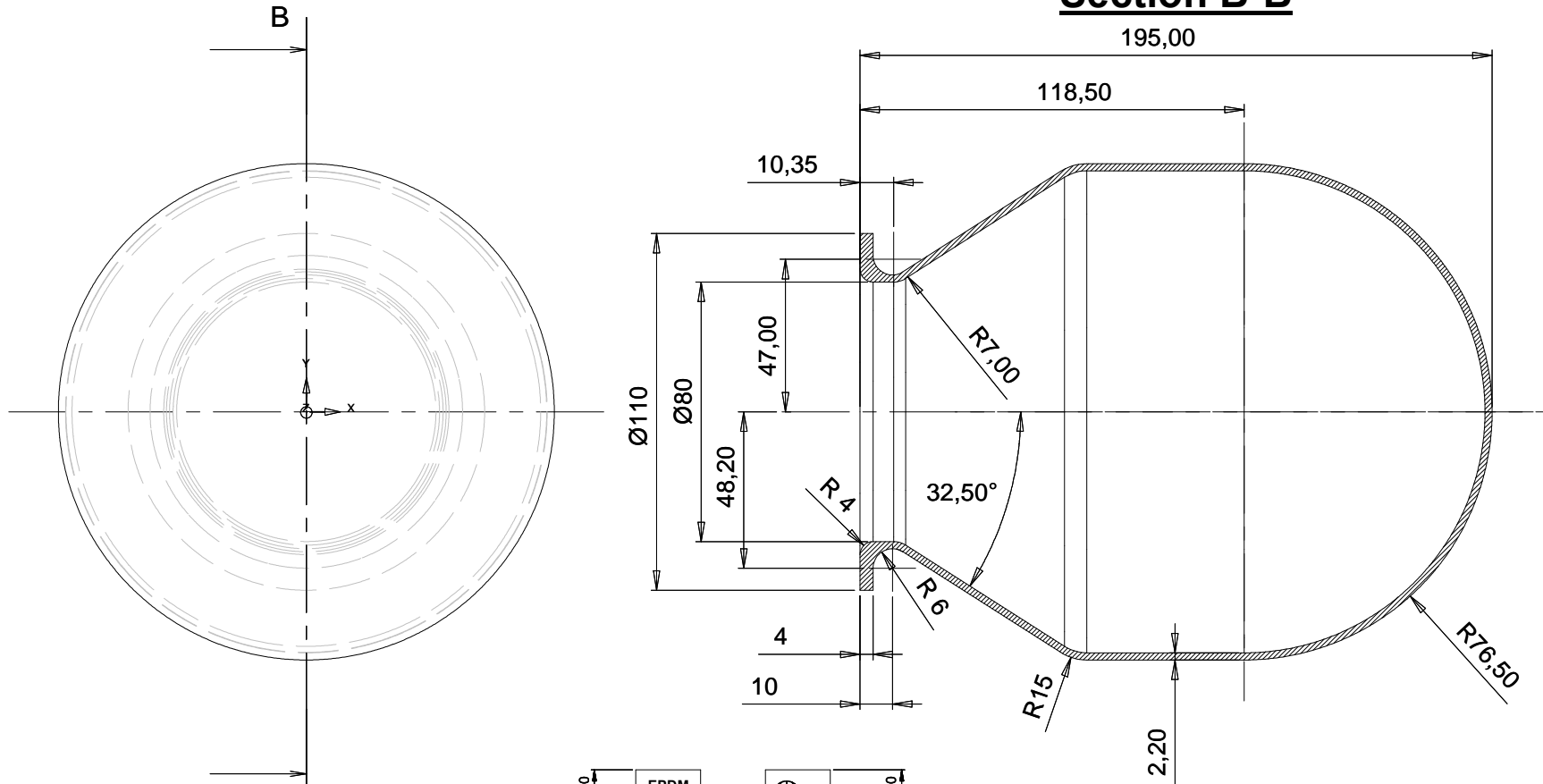

**MARCATURA : MATERIALE --- EPDM**  
**TIPO**  
**DATARIO**  
**N°VANO 1-12**

**MARK : MATERIAL --- EPDM**  
**TYPE**  
**DATA OF EXECUTION**  
**CAVITY N° 1-12**

QUOTE SENZA INDICAZIONE DI TOLLERANZA SECONDO : UNI ISO 2768-m		Toll. generali foro: HS Dim. lineari: JS Albero : h8 Angoli: 0°30'		INSCITTORE:
Vente de pompes, accessoires & pièces détachées de pompe				
Data: <b>01-10-2015</b>	1/1	VISTO:	COMMESSA N°:	
Rev. R: 1	data: 29-06-2005	Cod. mod. WCB 7.03.1	<b>9620</b>	







# Section A-A

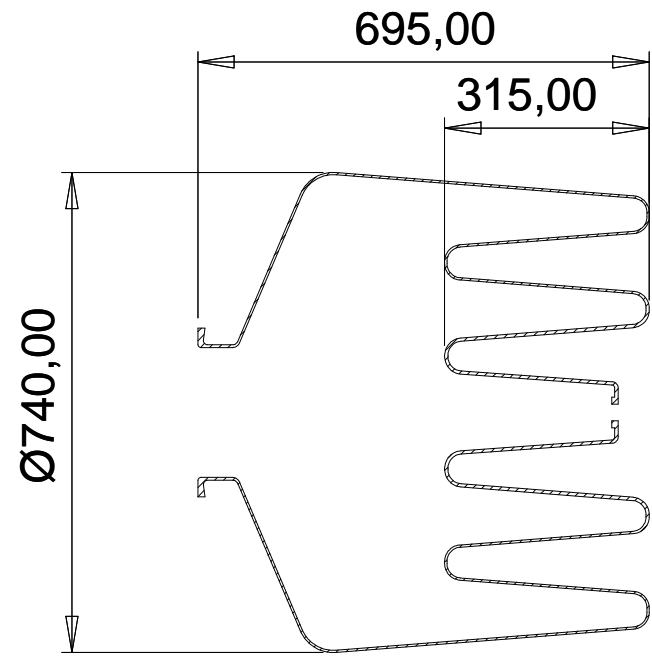

# Section B-B

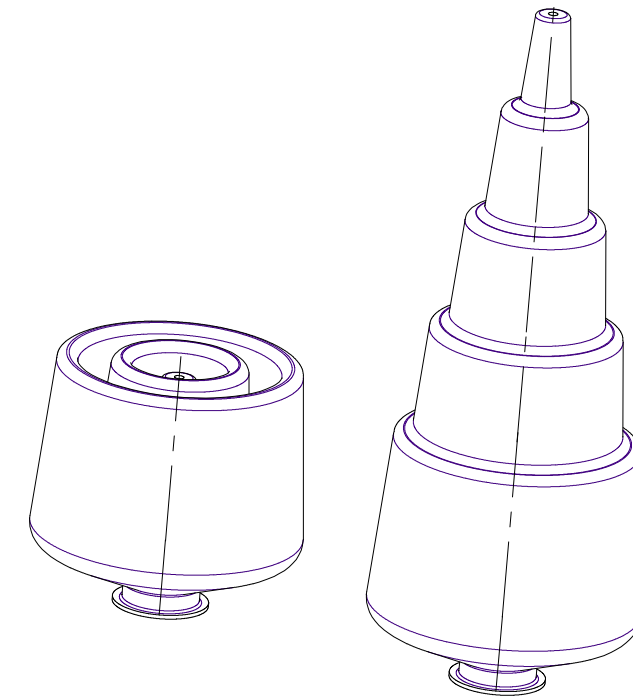
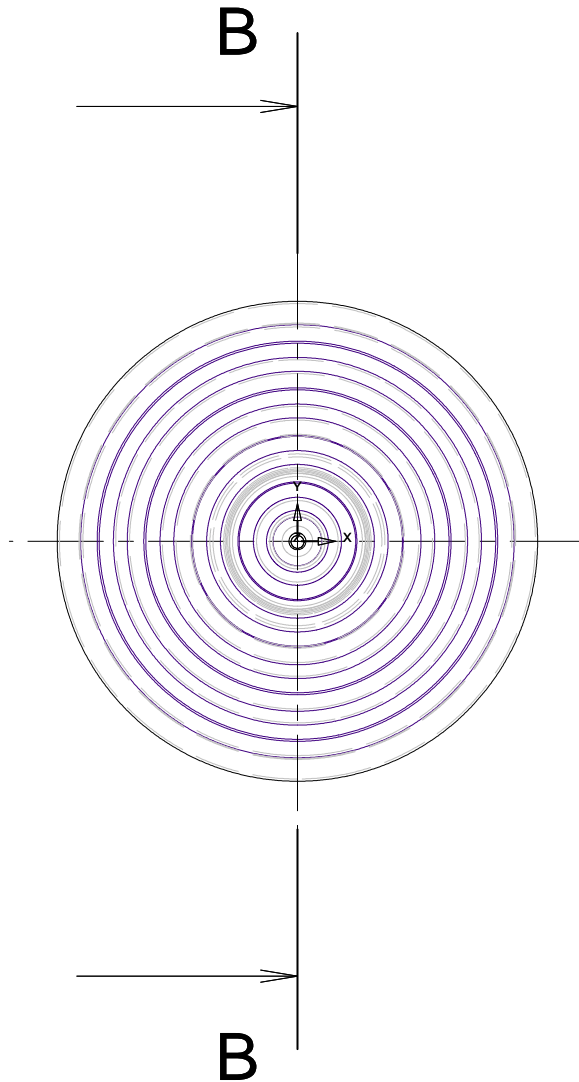
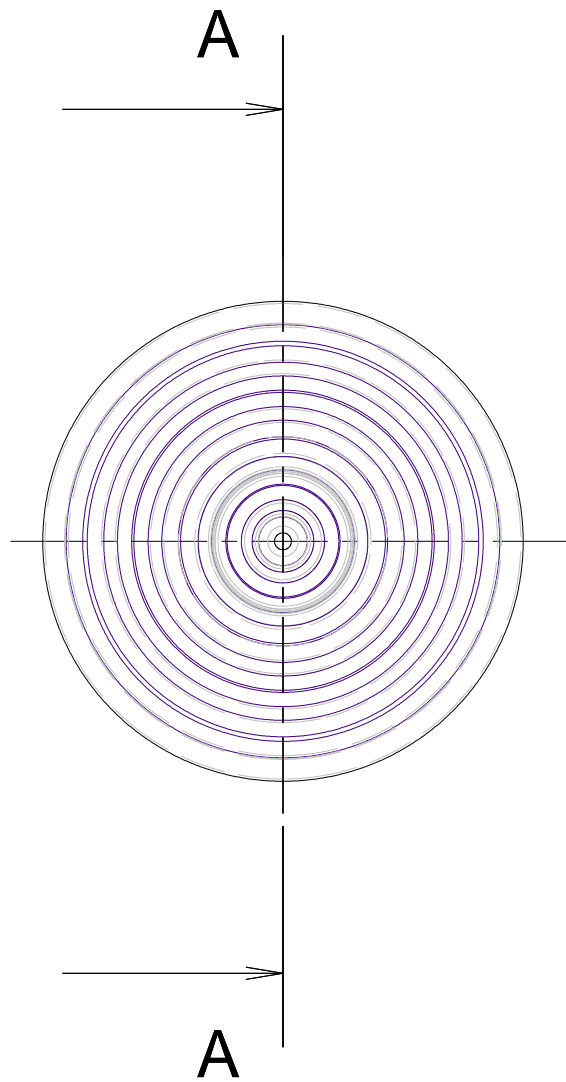
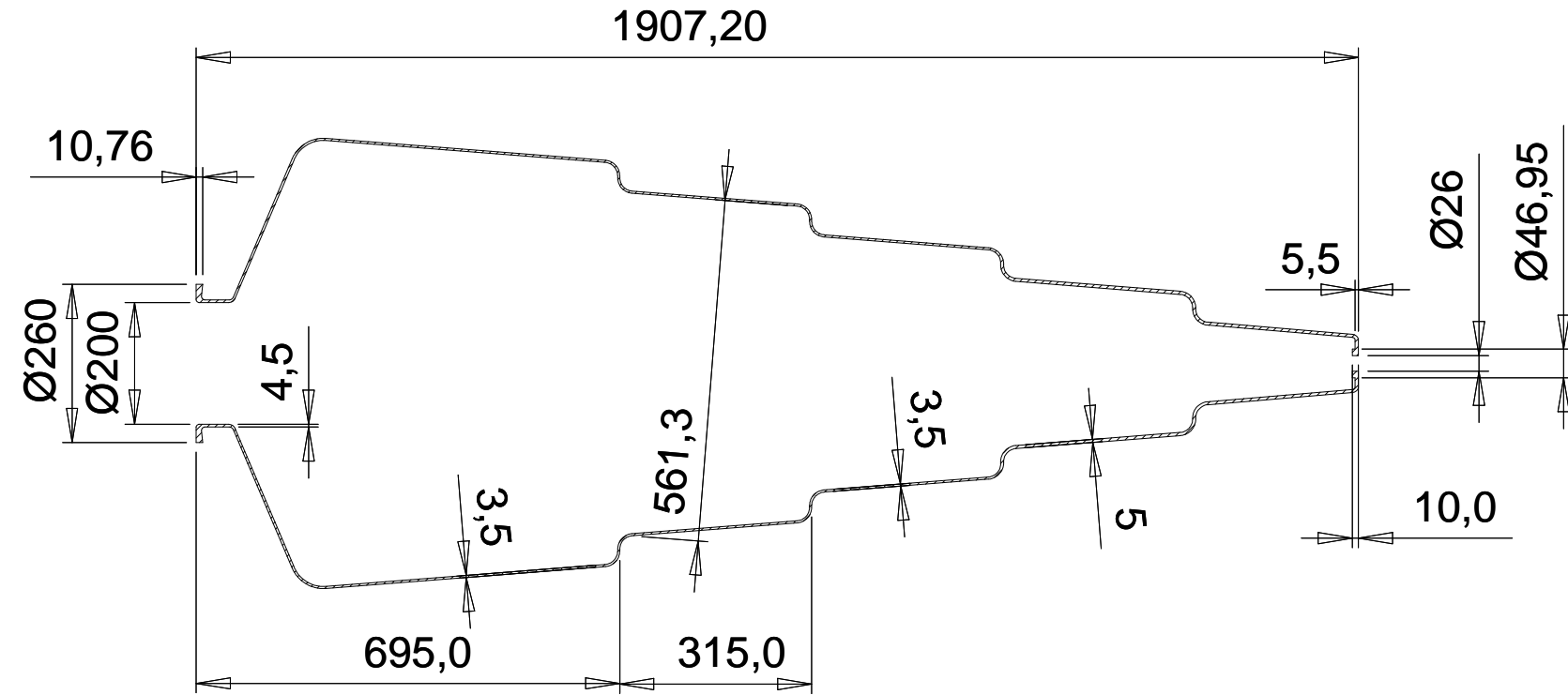

QUOTE SENZA INDICAZIONE DI TOLLERANZA SECONDO : UNI ISO 2768-m	Toll. generali foro: H8 Dim. lineari: j8 Albero : h8 Angoli : 0°30'		MODIFICHE:
<h2>Techni Pompe.fr</h2> <p>Vente de pompes, accessoires &amp; pièces détachées de pompe</p>			
Data: 10-09-2015	1/1	VISTO:	COMMESSA N°: 0210
<small>Rev. N. 1</small>	<small>Data: 29-04-2005</small>	<small>cod. mod. MCR 7.03.3</small>	

# Section A-A

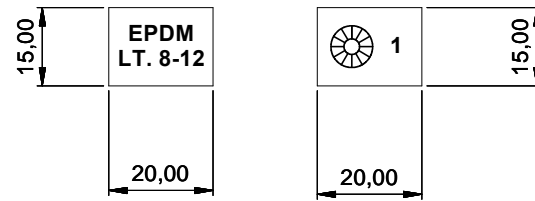
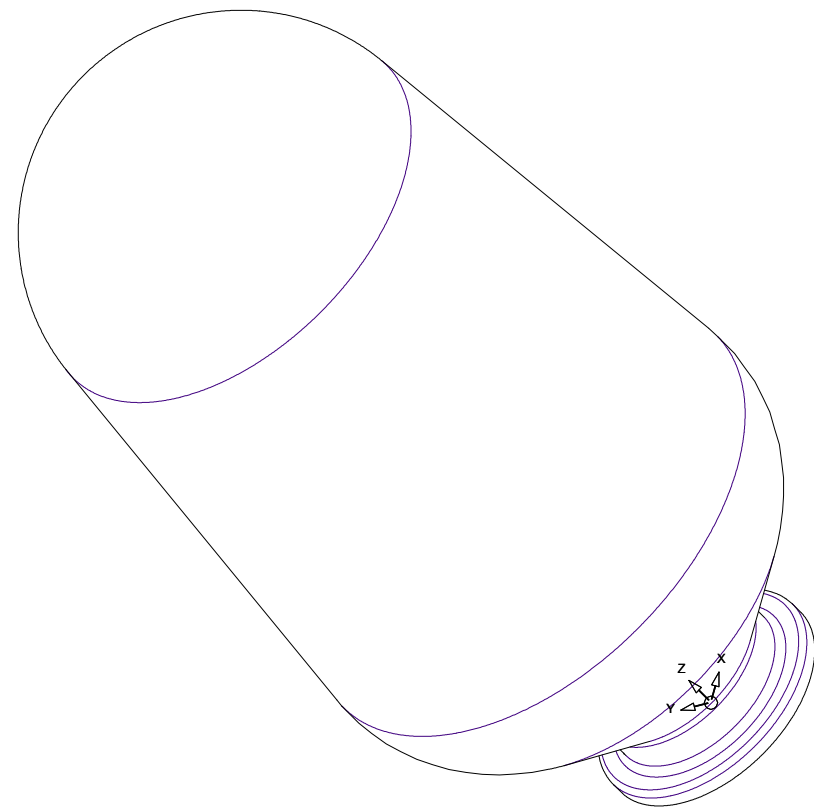
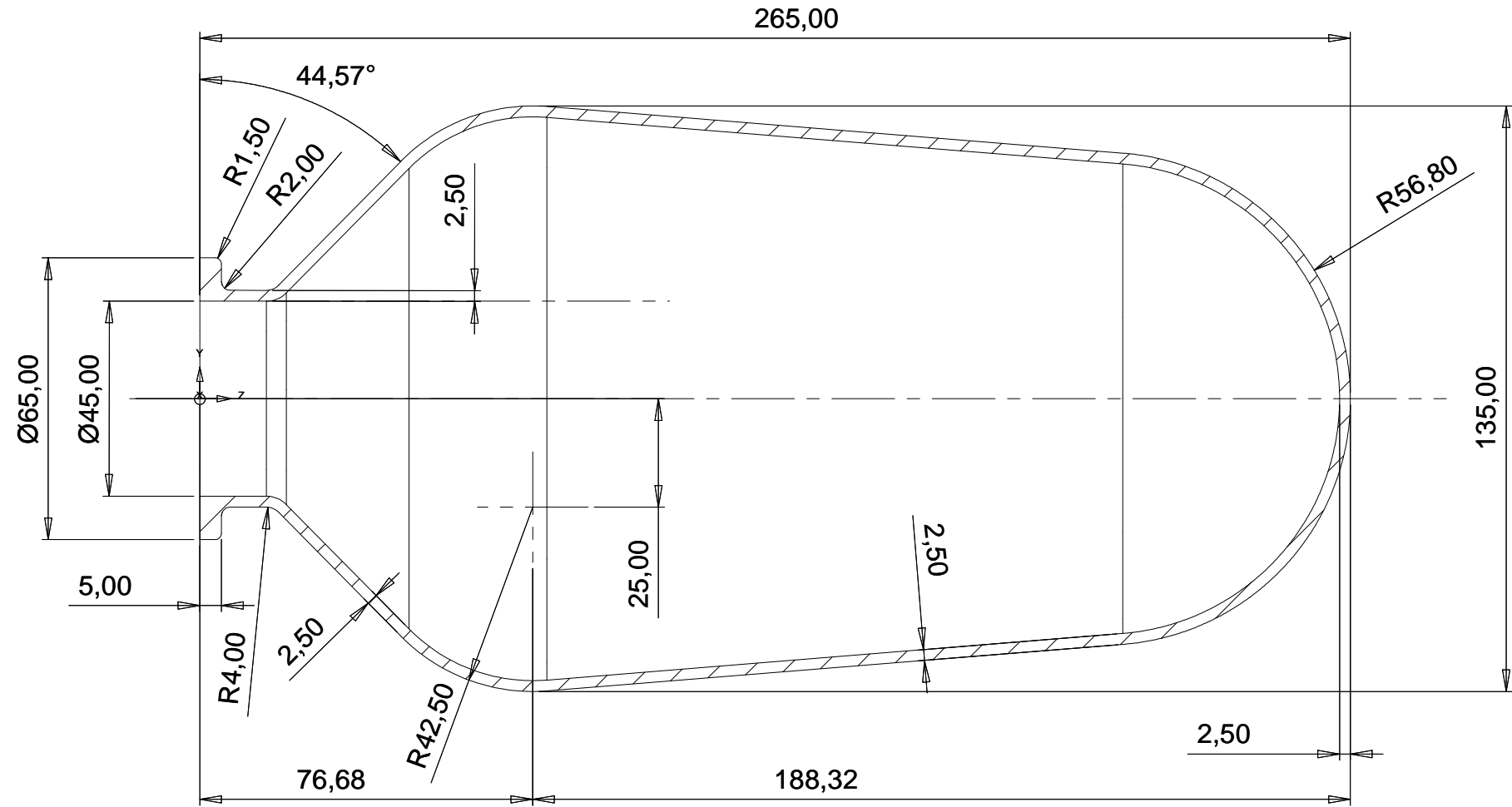
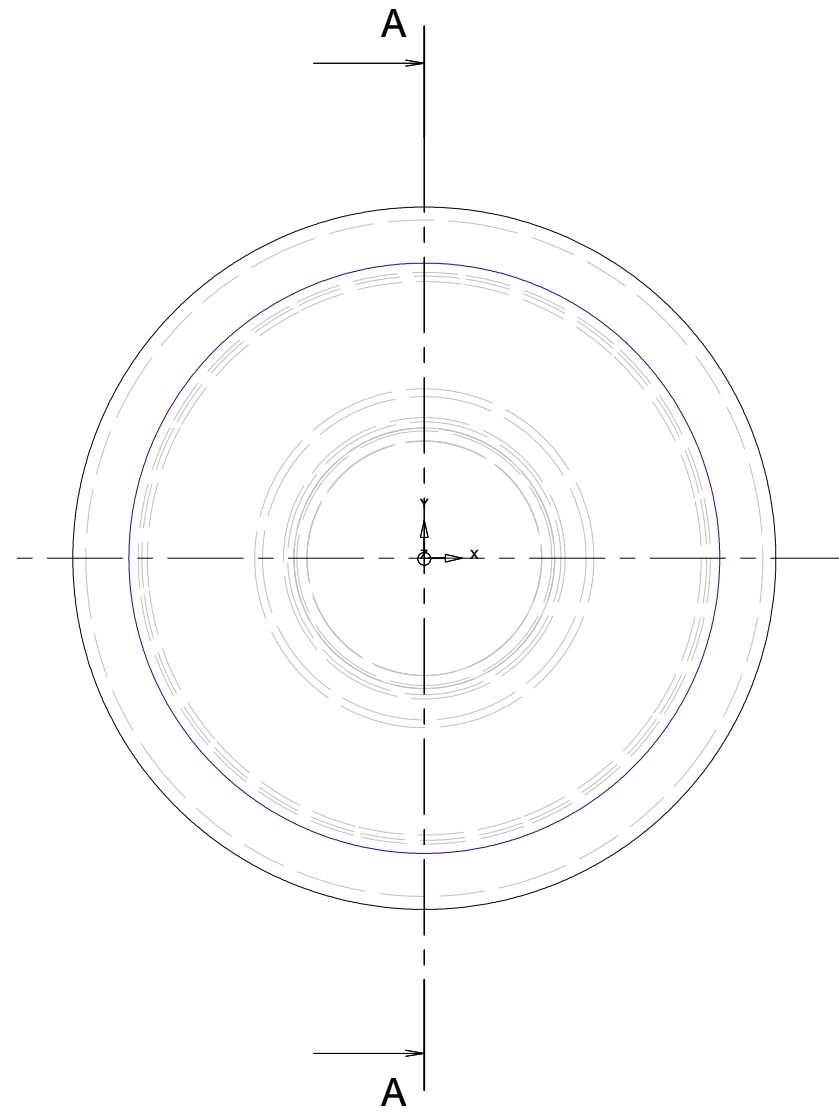

**MARCATURA : MATERIALE --- EPDM**  
**TIPO**  
**DATARIO**  
**N°VANO 1-12**

**MARK : MATERIAL --- EPDM**  
**TYPE**  
**DATA OF EXECUTION**  
**CAVITY N° 1-12**

<small>QUOTE SENZA INDICAZIONE DI TOLLERANZA SECONDO : UNI ISO 2768-m</small>		<small>Toll. generali foro:H8 Dim. lineari:j8 Albero : h8 Angoli: 0°30'</small>			<small>MODIFICHE:</small> 
<b>Vente de pompes, accessoires &amp; pièces détachées de pompe</b>					
<small>Disegnatore: BUTTARO</small>	<small>TAV. N°:</small>	<small>Fg. N°:</small>	<small>VISTO:</small>	<small>COMMESSA N°:</small>	
<small>Data: 03-09-2015</small>	<small>1/1</small>			<b>9618</b>	
<small>Rev. N. 1</small>	<small>Data 29-06-2005</small>	<small>Cod. mod. MCR 7.03.3</small>			

**Section A-A**

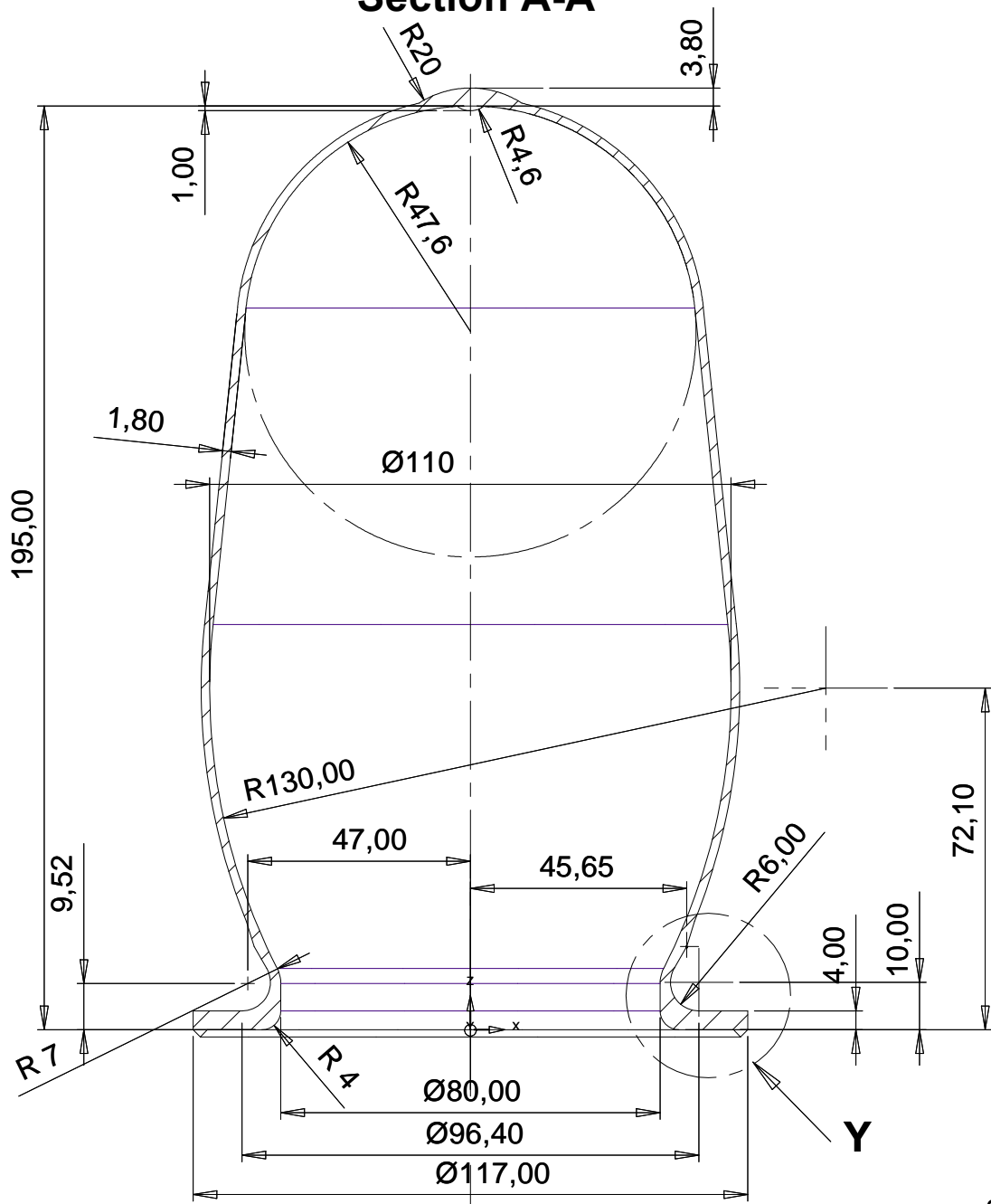

**MARCATURA : MATERIALE --- EPDM**  
**TIPO**  
**DATARIO**  
**N°VANO 1-12**

**MARK : MATERIAL --- EPDM**  
**TYPE**  
**DATA OF EXECUTION**  
**CAVITY N° 1-12**

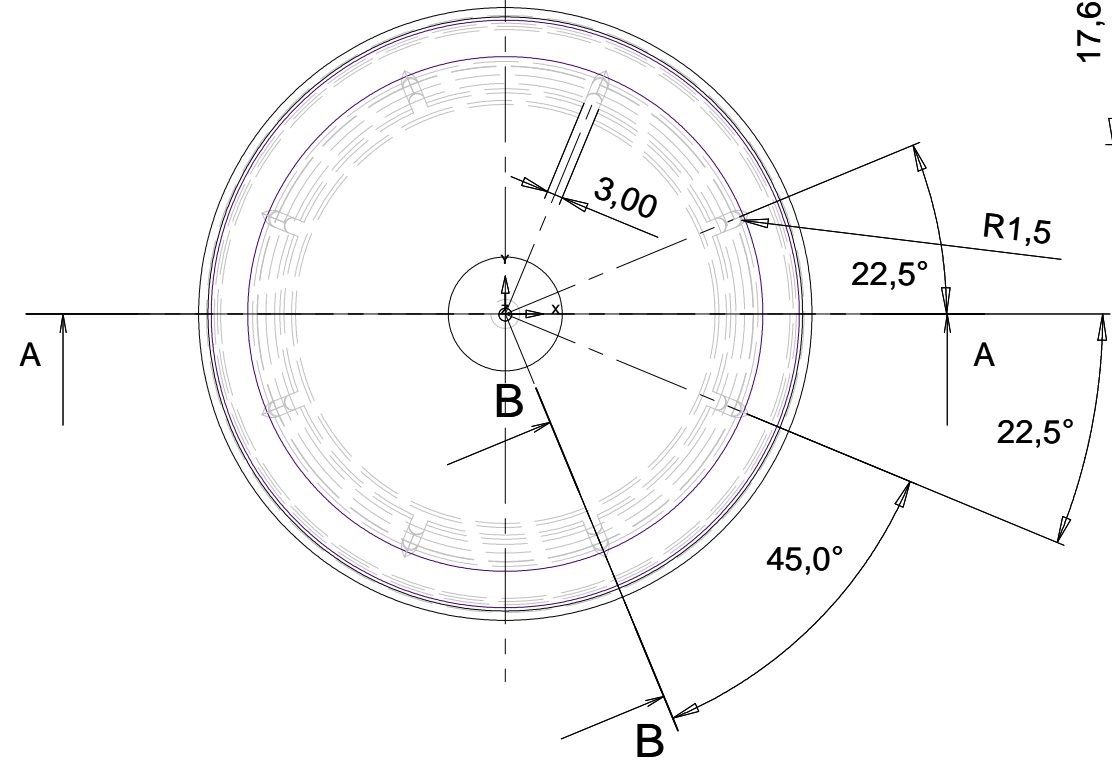
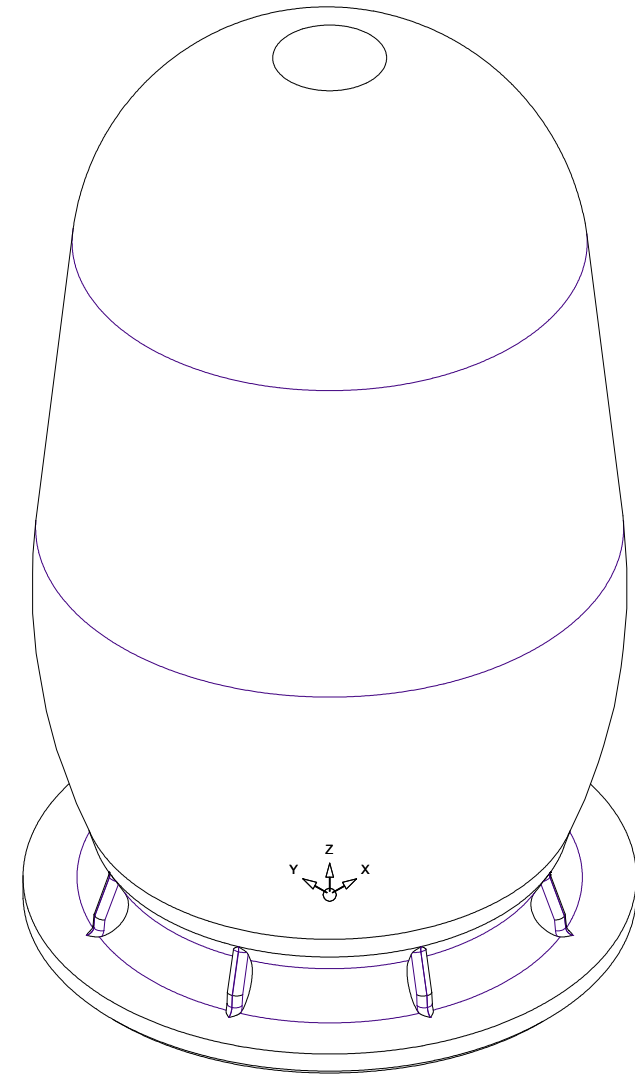
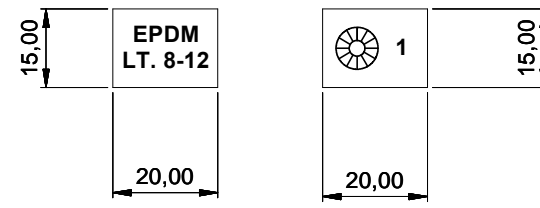

**DETTAGLIO Y**

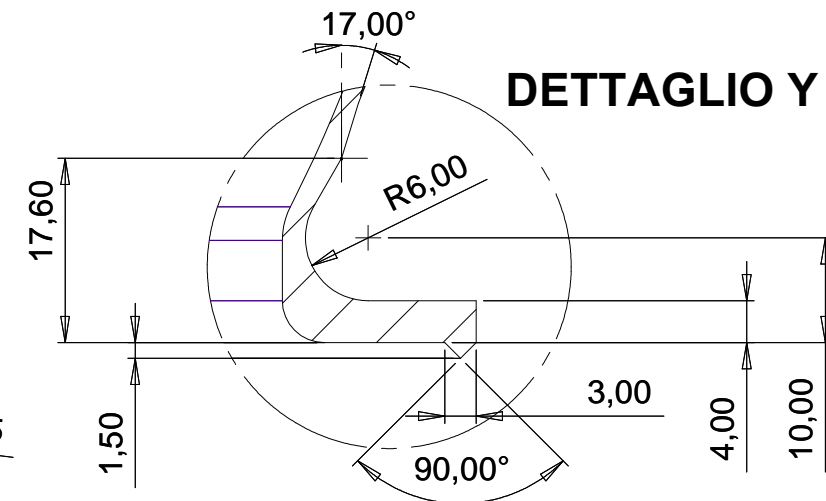

**SECTION B-B**

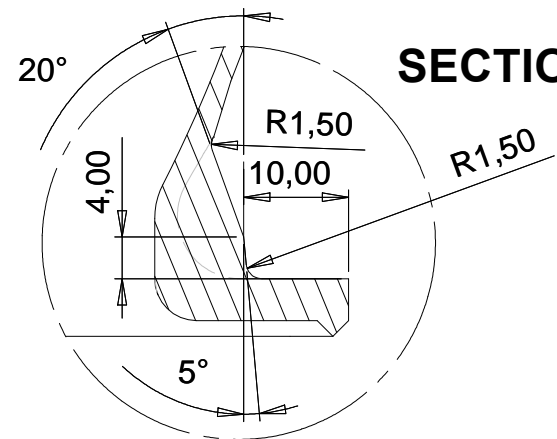

**CAPACITA'**  
**CAPACITY = 1401070 mm CUBICI**

QUOTE SENZA INDICAZIONE DI TOLLERANZA SECONDO : UNI ISO 2768-m	Toll. generali foro:H8 Dim. lineari:j8 Albero : h8 Angoli: 0°30'	
Vente de pompes, accessoires & pièces détachées de pompe		
Disegnatore: <b>DOTTERO</b>	PAV. N°:	Fg. N°:
Data: <b>03-09-2015</b>	<b>1/1</b>	VISTO:
Rev. N. 1	Data 29-06-2005	Cod. mod. MCR 7.03.3
		<b>COMMESSA N°:</b> <b>9632</b>



**Section A-A**

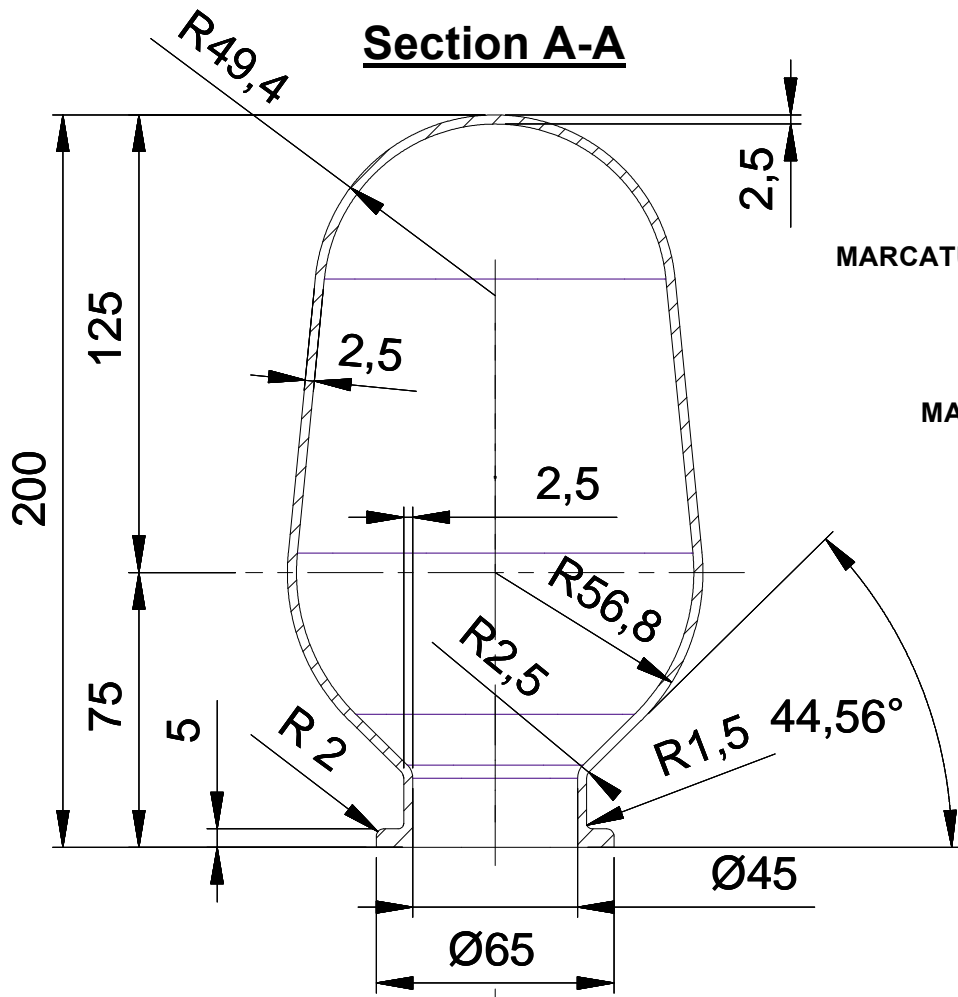

MARCATURA : MATERIALE --- EPDM  
 TIPO  
 DATARIO  
 N°VANO 1-12

MARK : MATERIAL --- EPDM  
 TYPE  
 DATA OF EXECUTION  
 CAVITY N° 1-12

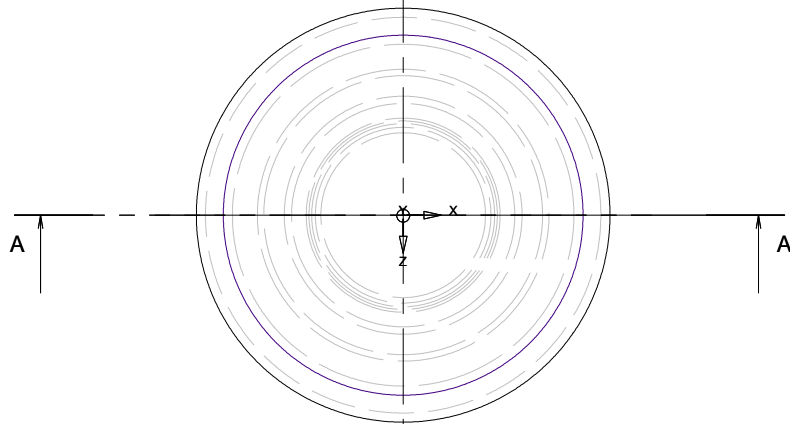
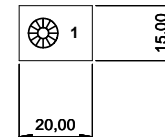
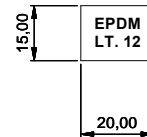
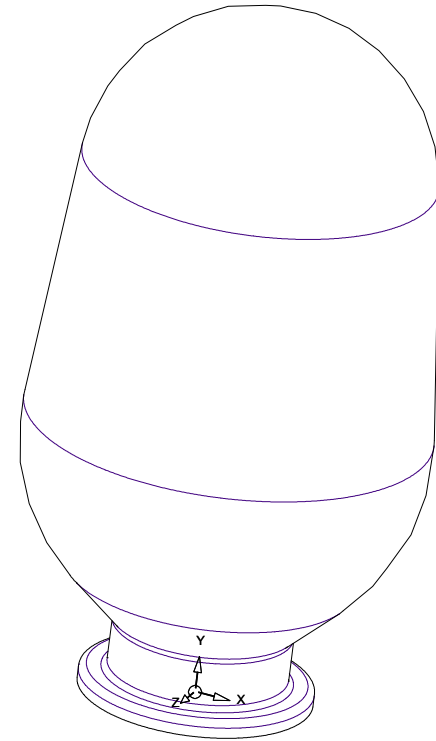

QUOTE SENZA INDICAZIONE DI TOLLERANZA SECONDO : UNI ISO 2768-m	Toll. generali foro: H8 Dim. lineari: j8 Albero : h8 Angoli: 0°30'		
<h1>Techni Pompe.fr</h1> <p>Vente de pompes, accessoires &amp; pièces détachées de pompe</p>			
Data: 13-12-2015 Rev. N. 1	FAV. N : 1/1 Data: 29-06-2005	VISTO:	COMMESSA N°: 9612 Cod. mod. MCP 1.03.3

MODIFICHE:

# Section A-A

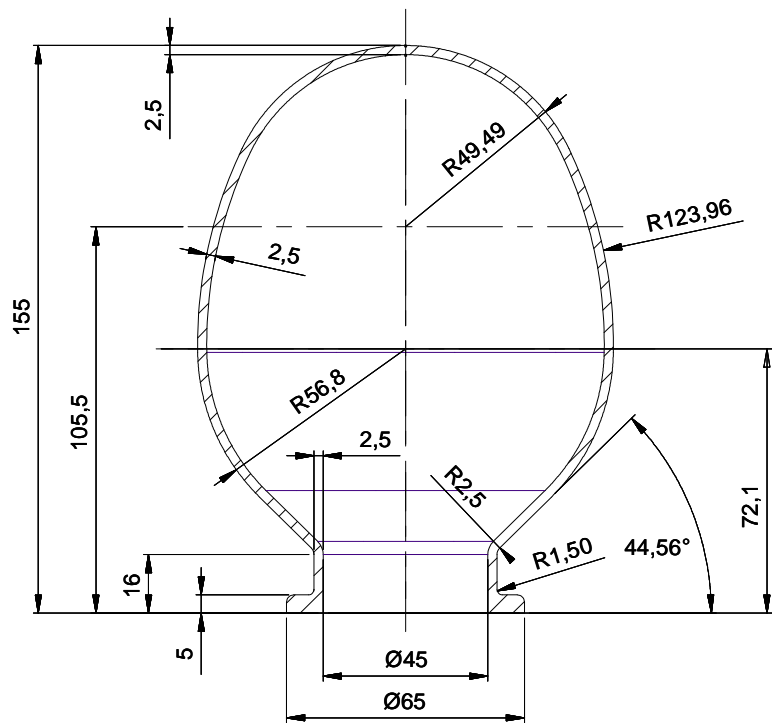

MARCATURA : MATERIALE --- BUTILE  
 TIPO  
 DATARIO  
 N°VANO 1-12

MARK : MATERIAL --- BUTYL  
 TYPE  
 DATA OF EXECUTION  
 CAVITY N° 1-12

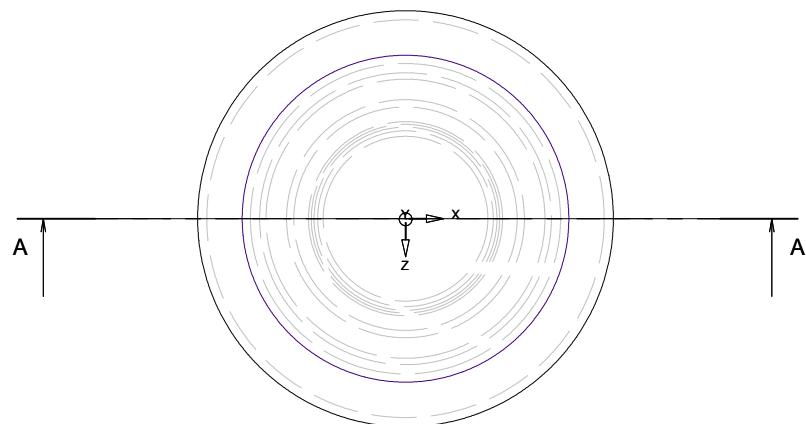
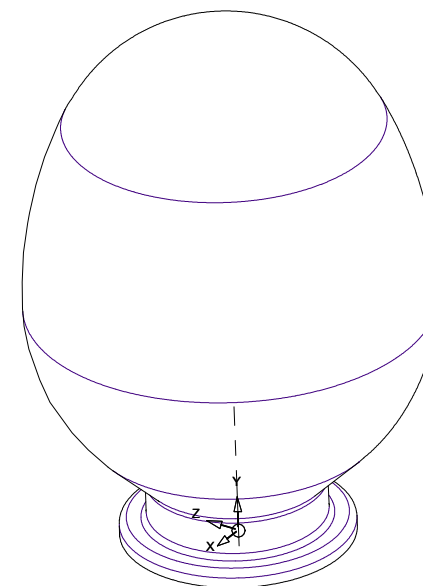
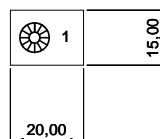
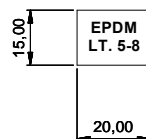

QUOTE SENZA INDICAZIONE DI TOLLERANZA SECONDO : UNI ISO 2768-m  
 Tolleranze generali foro: H8 Dim. lineari: js8  
 Albero : h8 Angoli: 0°30'

## Techni Pompe.fr

Vente de pompes, accessoires & pièces détachées de pompe

Data: 13-01-2015	1/1	VISTO:	COMMESSA N°: 9658
<small>Rev. N. 1</small>	<small>Data 29-06-2005</small>	<small>Cod. mod. MCR 7.03.3</small>	

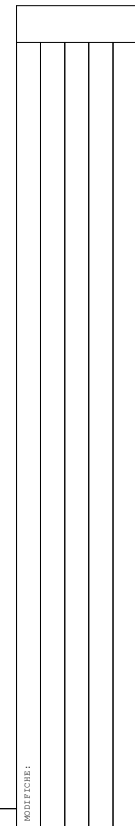

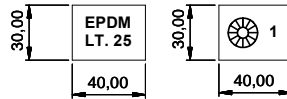
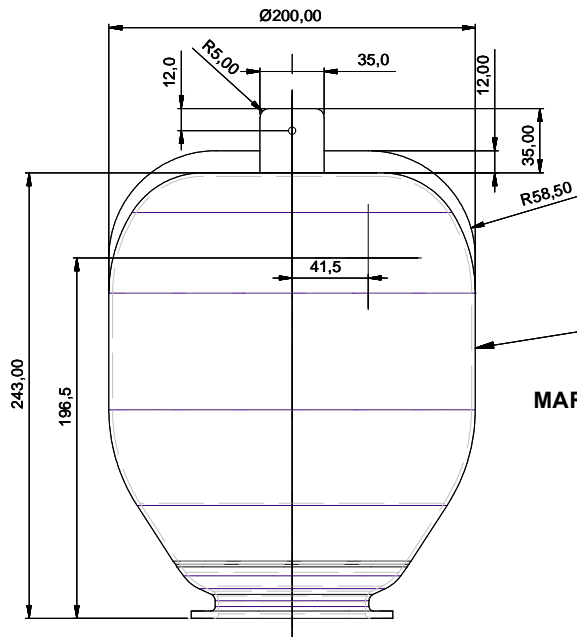

**ZONA MARCATURA**  
**MARK AREA**

MARCATURA : MATERIALE ---  
TIPO  
DATARIO  
N°VANO 1-12

MARK : MATERIAL ---  
TYPE  
DATA OF EXECUTION  
CAVITY N° 1-12

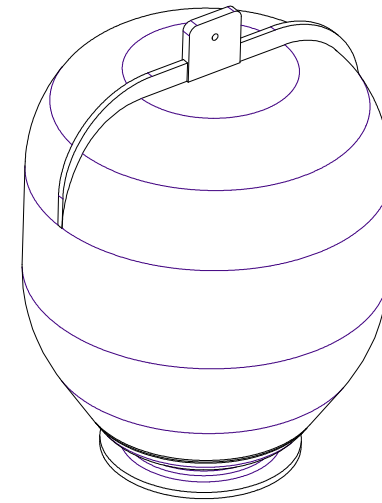

**Section A-A**

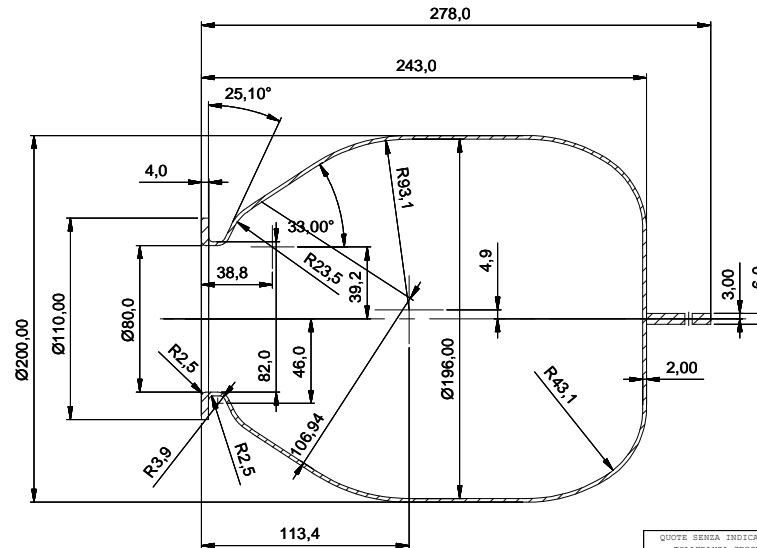
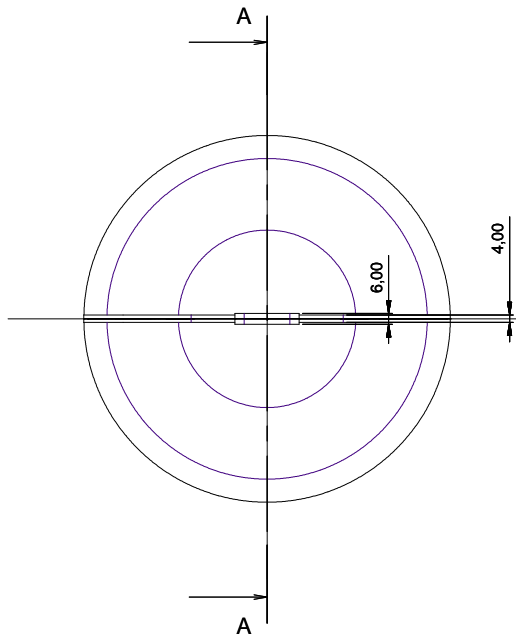

QUOTE SENZA INDICAZIONE DI TOLLERANZA SECONDO : UNI ISO 2768-m		Toll. generali foro: H8 Dim. lineari: j8 Albero : h8 Angoli : 0°30'			
<h1>Techni Pompe.fr</h1> <p>Vente de pompes, accessoires &amp; pièces détachées de pompe</p>					
Disegnatore:	<b>BOTTERO</b>	CAV. N°:		Fg. N°:	
Data:	<b>04-11-2014</b>	1/1	VISTO:	COMMESSA N°:	
Rev. N. 1		Data	29-05-2015	Cod. Mod. M2R 1.01.1	

MODIFICHE:

**9706**

**SEZIONE A-A**

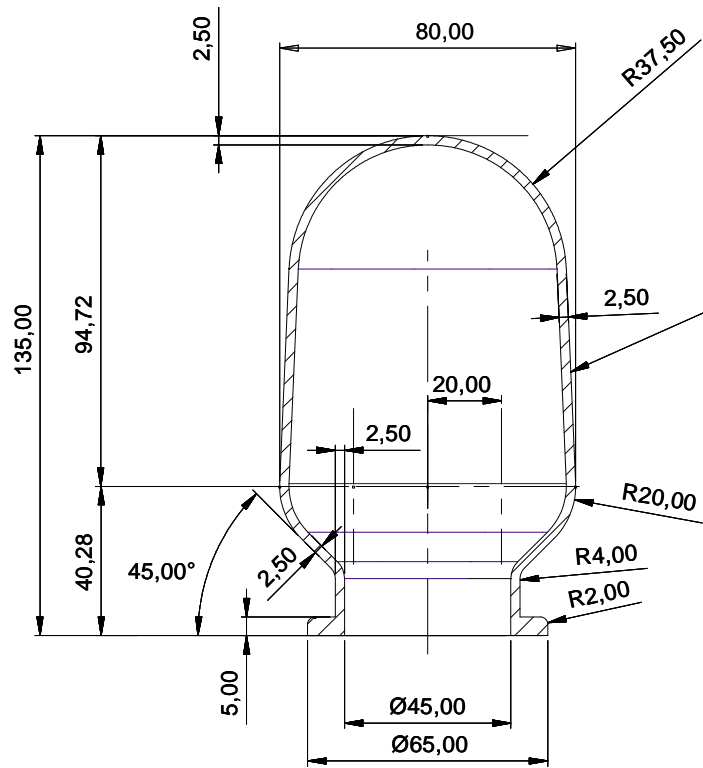

**ZONA MARCATURA**

**MARK AREA**

MARCATURA : MATERIALE --- NBR  
TIPO  
DATARIO  
N°VANO 1-12

MARK : MATERIAL --- NBR  
TYPE  
DATA OF EXECUTION  
CAVITY N° 1-12

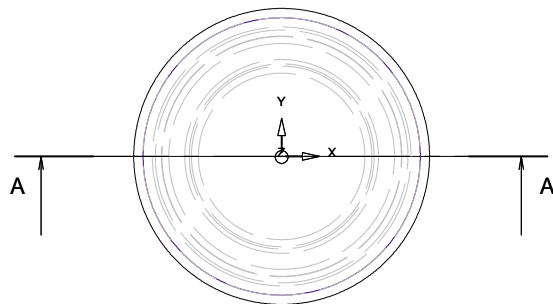
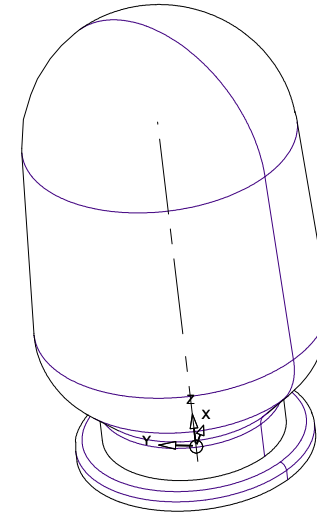
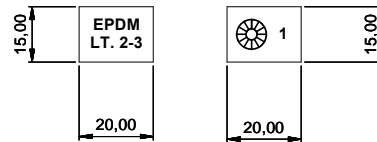

QUOTE SENZA INDICAZIONE DI TOLLERANZA SECONDO : UNI ISO 2768-m	Toll. generali foro:H8 Dim. lineari:js Albero : h8 Angoli: 0°30'		
--	--	--	--

**Techni Pompe.fr**  
Vente de pompes, accessoires & pièces détachées de pompe

Data: 04-11-2014	1/1	VISTO:	COMMESSA N°: 9623
Rev. 0: 1	Data: 23-02-2005	Cod. mod: MCR 1.03.3	

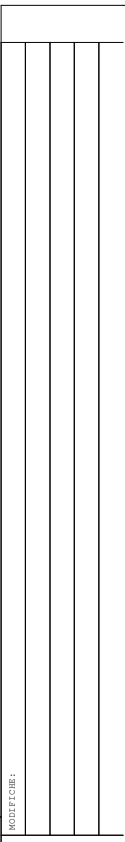

MODIFICHE: